

ok Need's post

564 R135

FOUND 3.5 INCH DIAMETER BRASS CAP IN TOP OF CONCRETE DRAINAGE STRUCTURE, STAMPED "U. S. COAST AND GEODETIC SURVEY BENCHMARK R135 1948". LOCATED APPROXIMATELY 84 FEET EAST OF THE EAST EDGE OF HIGHWAY 191, 1 FOOT SOUTH OF THE NORTH EDGE OF CONCRETE DRAINAGE STRUCTURE, 2.5 FEET SOUTH OF A CARSONITE POST, 0.5 FEET WEST OF THE EAST EDGE OF CONCRETE DRAINAGE STRUCTURE, 1.5 MILES SOUTH OF THE UNDERWOOD EXIT ROAD FOR I-80 ON THE EAST SIDE OF HIGHWAY 191, SEE NGS CONTROL. ON THE MCCLELLAND 7.5 MINUTE QUADRANGLE.

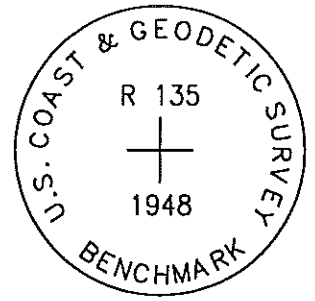

| PT# | NAME OR DESIGNATION | GEODEIC NAD83 (1996)         |                              |  | HEIGHT ELLIPSOID METERS | SP NAD83 (1996) IOWA SOUTH HEIGHT |                |               | SP NAD83 (1996) IOWA SOUTH HEIGHT |                 |                |
|-----|---------------------|------------------------------|------------------------------|--|-------------------------|-----------------------------------|----------------|---------------|-----------------------------------|-----------------|----------------|
|     |                     | LATITUDE (North) DEG MIN SEC | LONGITUDE (West) DEG MIN SEC |  |                         | NORTHING METERS                   | EASTING METERS | NAVD88 METERS | NORTHING US FEET                  | EASTING US FEET | NAVD88 US FEET |
| 564 | R 135               | 41 21 23.91987               | 95 42 07.25337               |  | 292.34                  | 152986.308                        | 315763.832     | 320.28        | 501922.58                         | 1035968.51      | 1050.8         |

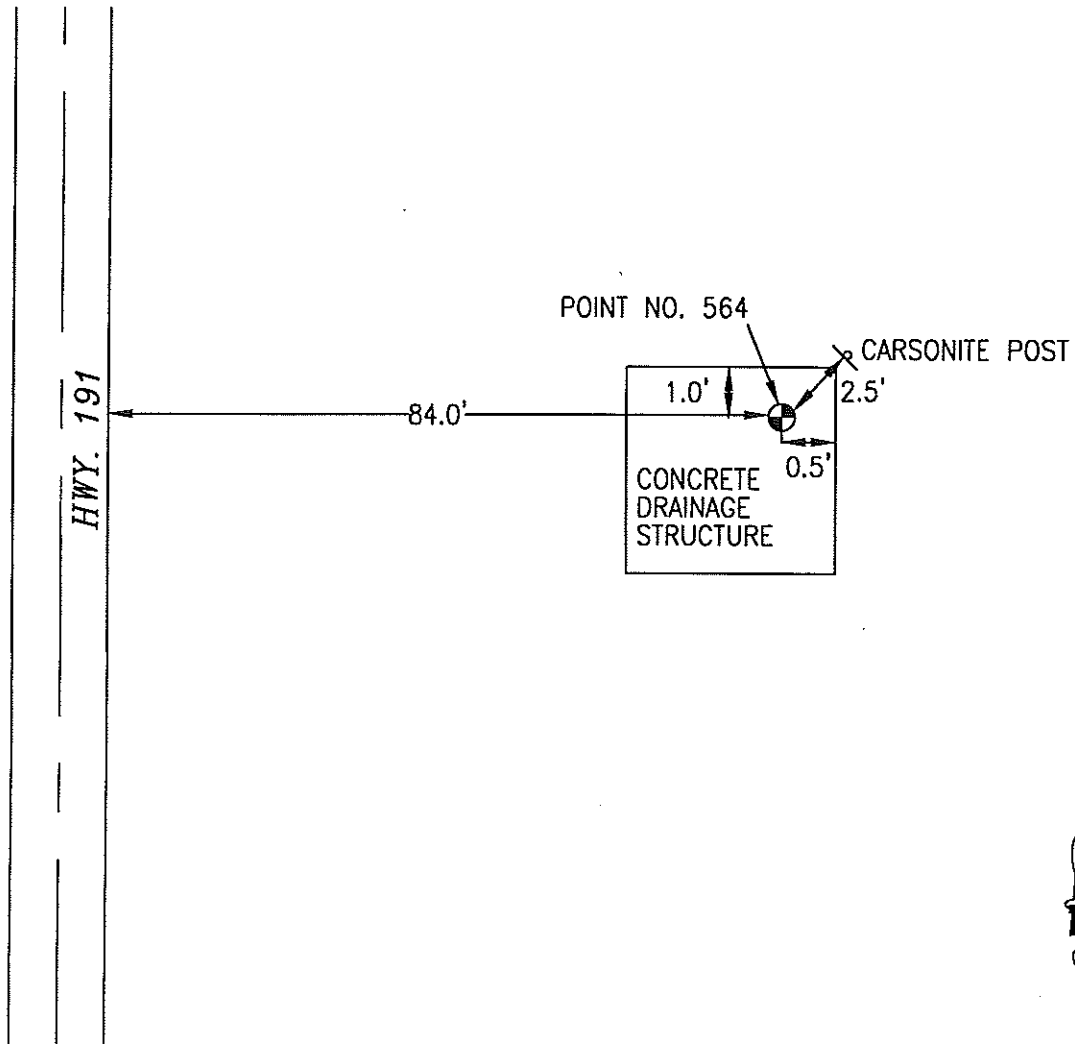

NOT TO SCALE

LOCATION DIAGRAM  
POTTAWATTAMIE COUNTY IOWA  
GIS Mapping Project  
GPS Survey Report

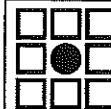

**MERRICK**

Engineers & Architects

2450 S. Peoria Street Aurora, Colorado 80014 (303)751-0741

Job Number: 50013142

Date: October 28, 1998