

OK

567 764132-3

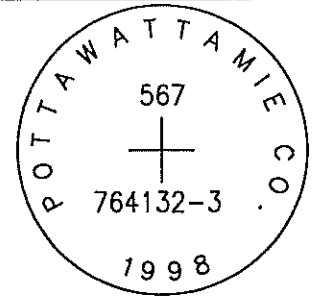

SET 5/8 INCH DIAMETER ROD WITH 2.5 INCH DIAMETER CAP, 0.3 FEET BELOW GROUND, STAMPED "POTTAWATTAMIE CO. 1998, 567, 764132-3". LOCATED APPROXIMATELY 35 FEET EAST OF THE EAST EDGE OF 310TH STREET, 48 FEET NORTH OF THE NORTH EDGE OF IDLEWOOD ROAD, 24 FEET NORTHWEST OF A STREET SIGN, 32 FEET NORTHWEST OF A STOP SIGN, 17.5 FEET NORTHWEST OF A BURIED CABLE SIGN. ON THE TAYLOR 7.5 MINUTE QUADRANGLE.

PT#	NAME OR DESIGNATION	GEODETC NAD83 (1996)			HEIGHT ELLIPSOID METERS	SP NAD83 (1996) IOWA SOUTH HEIGHT			SP NAD83 (1996) IOWA SOUTH HEIGHT		
		LATITUDE (North) DEG MIN SEC	LONGITUDE (West) DEG MIN SEC			NORTHING METERS	EASTING METERS	NAVD88 METERS	NORTHING US FEET	EASTING US FEET	NAVD88 US FEET
567	764132-3	41 19 57.78960	95 35 37.86363	338.28	150106.601	324747.837	366.02	492474.74	1065443.53	1200.9	

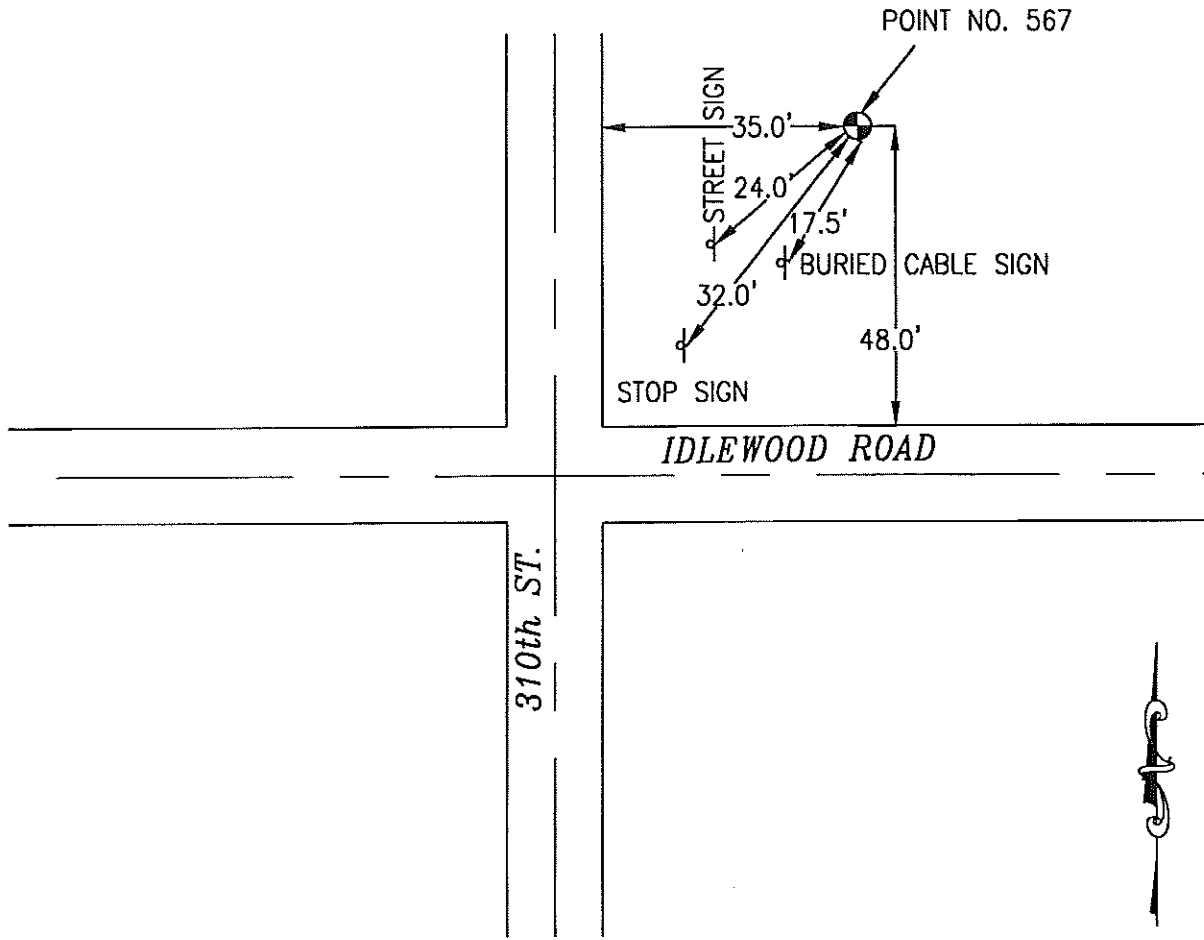

NOT TO SCALE

LOCATION DIAGRAM  
 POTTAWATTAMIE COUNTY IOWA  
 GIS Mapping Project  
 GPS Survey Report

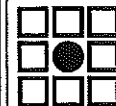

**MERRICK**  
 Engineers & Architects

2450 S. Pearla Street Aurora, Colorado 80014 (303)751-0741  
 Job Number: 50013142  
 Date: October 28, 1998