

ok

579 754207-1

SET 5/8 INCH DIAMETER ROD WITH 2.5 INCH DIAMETER CAP, 0.3 FEET BELOW GROUND, STAMPED "POTTAWATTAMIE CO. 1998, 579, 754207-1". LOCATED APPROXIMATELY 48 FEET NORTH OF THE NORTH EDGE OF HUNT AVENUE (COUNTY ROAD 6L), 11 FEET EAST OF THE EAST EDGE OF A DIRT ROAD, 13 FEET SOUTH OF A FOUND STEEL FENCEPOST, 2.1 FEET SOUTHWEST OF A FOUND STEEL FENCEPOST, 1.7 FEET WEST OF A SET ORANGE CARSONITE POST. ON THE MCCLELLAND 7.5 MINUTE QUADRANGLE.

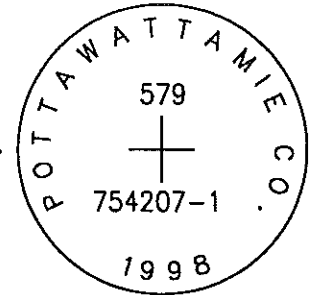

PT#	NAME OR DESIGNATION	GEODEIC NAD83 (1996)			HEIGHT ELLIPSOID METERS	SP NAD83 (1996) IOWA SOUTH HEIGHT			SP NAD83 (1996) IOWA SOUTH HEIGHT		
		LATITUDE (North) DEG MIN SEC	LONGITUDE (West) DEG MIN SEC			NORTHING METERS	EASTING METERS	NAVD88 METERS	NORTHING US FEET	EASTING US FEET	NAVD88 US FEET
579	754207-1	41 18 41.91139	95 43 04.52759		352.58	148024.017	314305.597	380.31	485642.13	1031184.28	1247.7

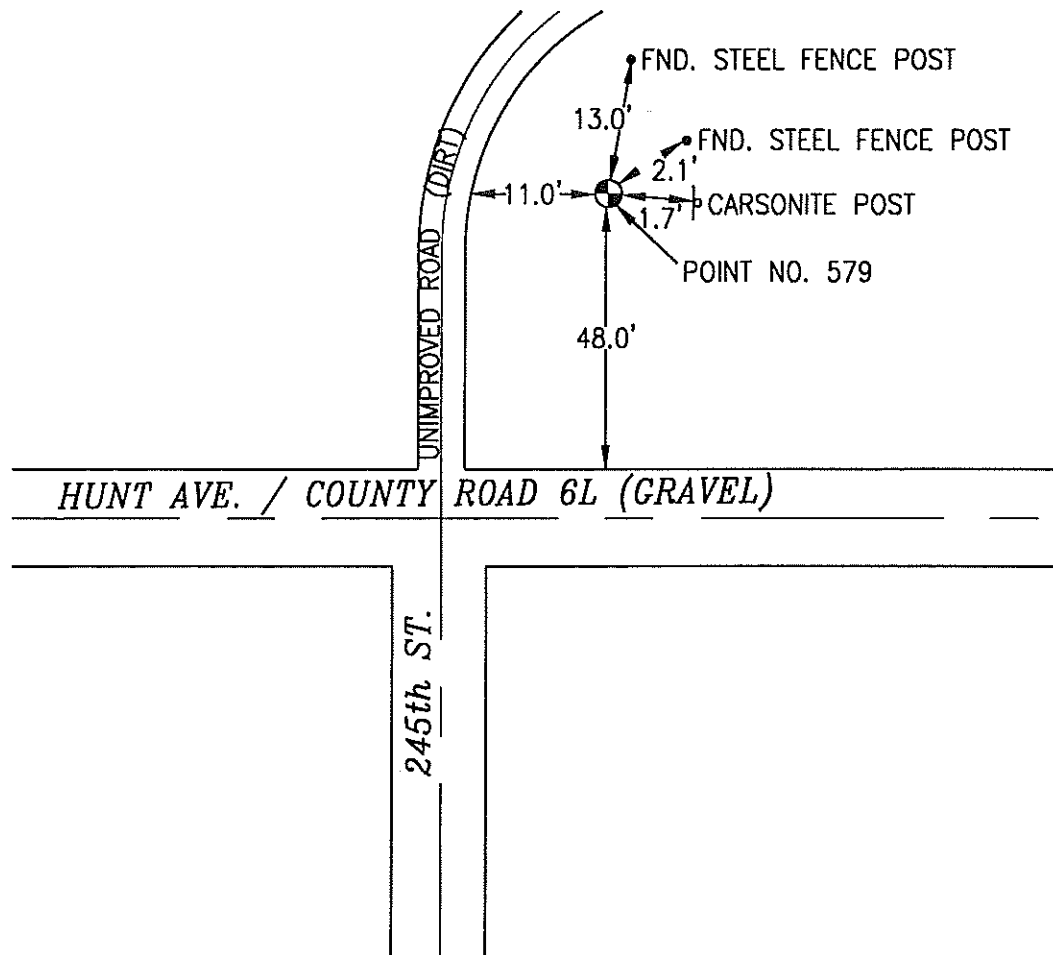

NOT TO SCALE

LOCATION DIAGRAM  
POTTAWATTAMIE COUNTY IOWA  
GIS Mapping Project  
GPS Survey Report



**MERRICK**

Engineers & Architects

2450 S. Peoria Street Aurora, Colorado 80014 (303)751-0741

Job Number: 50013142

Date: November 3, 1998