

OK

586

753913-3

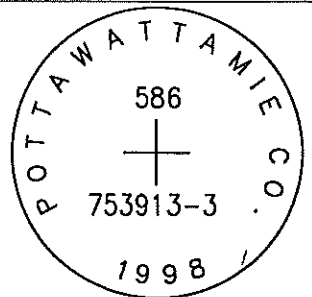

SET 5/8 INCH DIAMETER ROD WITH 2.5 INCH DIAMETER CAP, 0.8 FEET BELOW GROUND, STAMPED "POTTAWATTAMIE CO. 1998, 586, 753913-3". LOCATED APPROXIMATELY 9 FEET EAST OF THE EAST EDGE OF GRAVEL 470TH STREET, 3 FEET SOUTH OF A ORANGE CARSONITE POST, 17.5 FEET WEST OF END OF FENCE, 52.5 FEET NORTH OF STOP SIGN, ON THE NORTH SIDE OF HACKBERRY ROAD EXTENDED. ON THE AVOCA SE 7.5 MINUTE QUADRANGLE.

PT#	NAME OR DESIGNATION	GEODEIC NAD83 (1996)			HEIGHT ELLIPSOID METERS	SP NAD83 (1996) IOWA SOUTH HEIGHT			SP NAD83 (1996) IOWA SOUTH HEIGHT		
		LATITUDE (North) DEG MIN SEC	LONGITUDE (West) DEG MIN SEC			NORTHING METERS	EASTING METERS	NAVD88 METERS	NORTHING US FEET	EASTING US FEET	NAVD88 US FEET
586	753913-3	41 17 20.49341	95 17 20.33552	351.71	144685.750	350161.210	379.41	474689.83	1148820.57	1244.8	

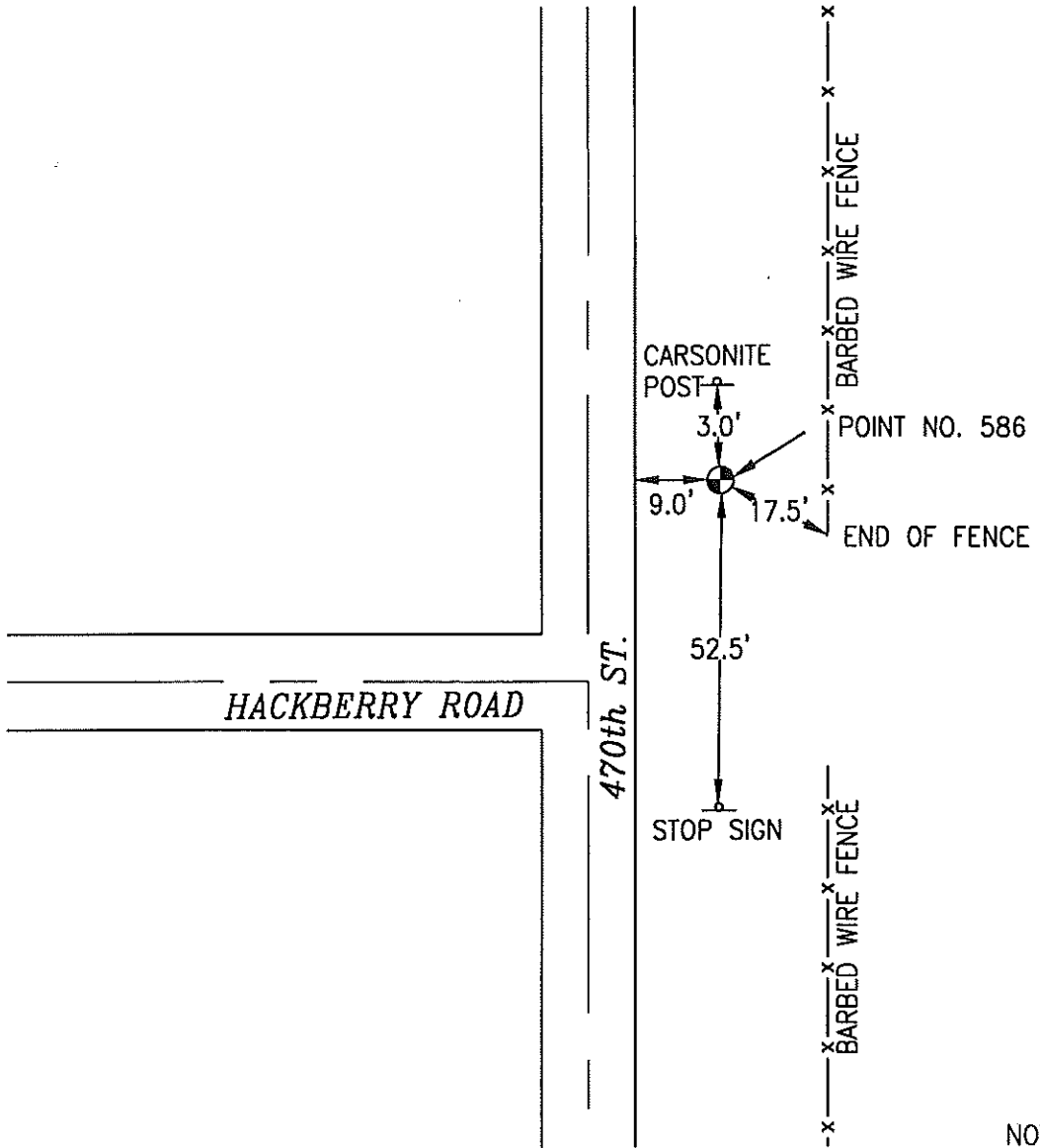

NOT TO SCALE

LOCATION DIAGRAM
 POTTAWATTAMIE COUNTY IOWA
 GIS Mapping Project
 GPS Survey Report

MERRICK
 Engineers & Architects
 2450 S. Pearla Street Aurora, Colorado 80014 (303)751-0741
 Job Number: 50013142
 Date: November 3, 1998