

ok

587 753816-3

SET 5/8 INCH DIAMETER ROD WITH 2.5 INCH DIAMETER CAP, 0.3 FEET BELOW GROUND, STAMPED "POTTAWATTAMIE CO. 1998, 587, 753816-3". LOCATED APPROXIMATELY 40 FEET EAST OF THE EAST EDGE OF ASPHALT EXTENDED 500TH STREET (COUNTY ROAD M47), 27 FEET NORTH OF THE NORTH EDGE OF GRAVEL HACKBERRY ROAD, 16.3 FEET NORTHWEST OF A STOP SIGN, 11.7 FEET SOUTHEAST OF A STREET INTERSECTION SIGN, 3 FEET SOUTH OF A ORANGE CARSONITE POST. ON THE ATLANTIC SW 7.5 MINUTE QUADRANGLE.

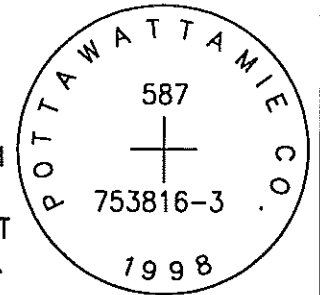

PT#	NAME OR DESIGNATION	GEODETIC NAD83 (1996)		HEIGHT ELLIPSOID METERS	SP NAD83 (1996) IOWA SOUTH HEIGHT			SP NAD83 (1996) IOWA SOUTH HEIGHT		
		LATITUDE (North) DEG MIN SEC	LONGITUDE (West) DEG MIN SEC		NORTHING METERS	EASTING METERS	NAVD88 METERS	NORTHING US FEET	EASTING US FEET	NAVD88 US FEET
587	753816-3	41 17 20.16530	95 13 56.20618	352.22	144579.500	354909.577	379.96	474341.24	1164399.17	1246.6

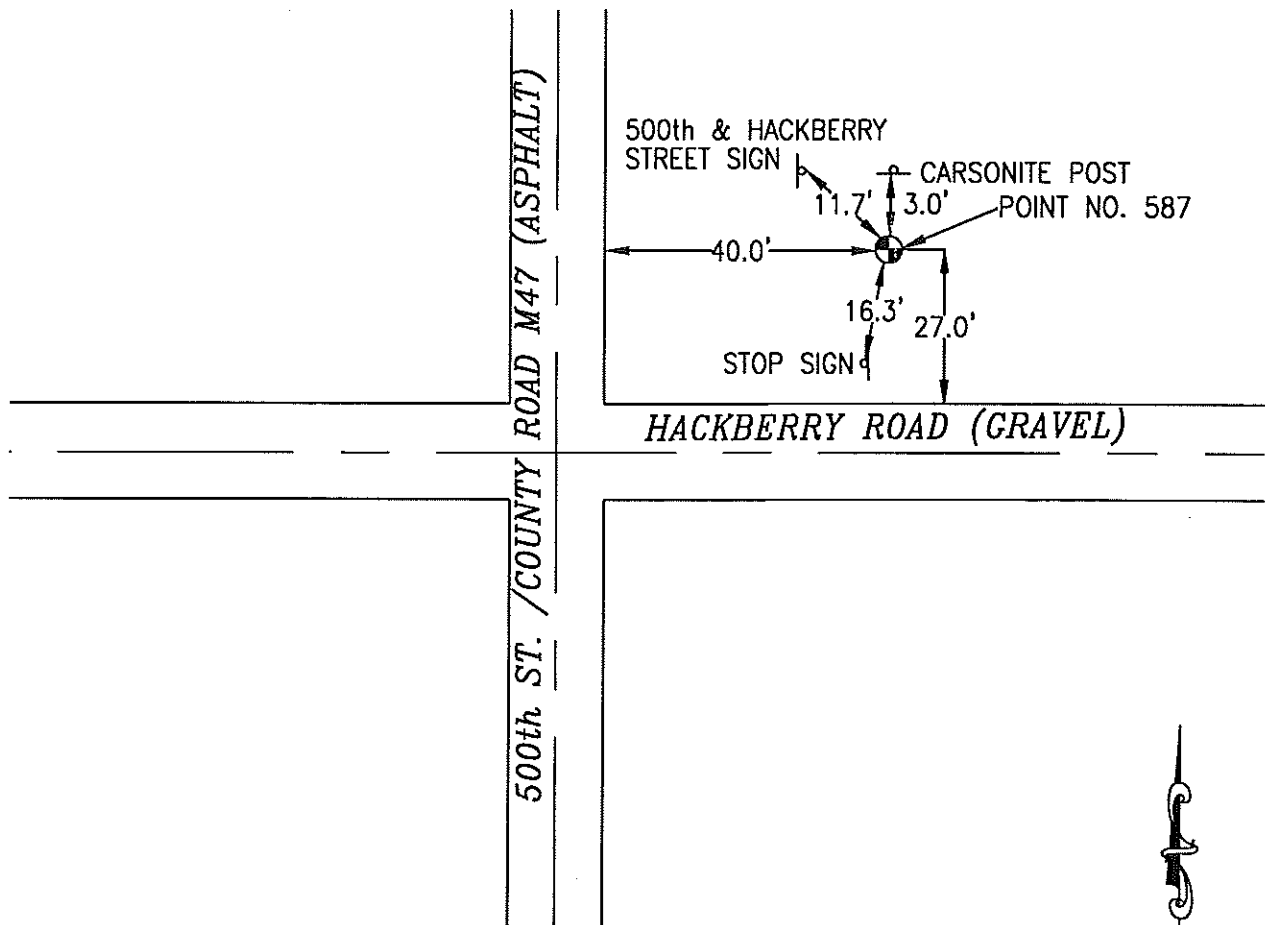

NOT TO SCALE

LOCATION DIAGRAM
 POTTAWATTAMIE COUNTY IOWA
 GIS Mapping Project
 GPS Survey Report

MERRICK
 Engineers & Architects
 2450 S. Peoria Street Aurora, Colorado 80014 (303)751-0741
 Job Number: 50013142
 Date: November 3, 1998