

OK

593 754220-3

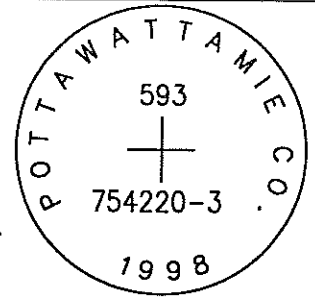

SET 5/8 INCH DIAMETER ROD WITH 2.5 INCH DIAMETER CAP, 0.3 FEET BELOW GROUND, STAMPED "POTTAWATTAMIE CO. 1998, 593, 754220-3". LOCATED APPROXIMATELY 19 FEET NORTH OF THE NORTH EDGE OF MCPHERSON AVENUE, 25 FEET EAST OF A MAILBOX AT ADDRESS 25190, 3 FEET SOUTHWEST OF A CARSONITE POST, 11.5 FEET SOUTHWEST OF A STOP SIGN, ON THE WEST SIDE OF EMERALD AVENUE. ON THE MCCLELLAND 7.5 MINUTE QUADRANGLE.

PT#	NAME OR DESIGNATION	GEODETC NAD83 (1996)			HEIGHT ELLIPSOID METERS	SP NAD83 (1996) IOWA SOUTH HEIGHT			SP NAD83 (1996) IOWA SOUTH HEIGHT		
		LATITUDE (North) DEG MIN SEC	LONGITUDE (West) DEG MIN SEC			NORTHING METERS	EASTING METERS	NAVD88 METERS	NORTHING US FEET	EASTING US FEET	NAVD88 US FEET
593	754220-3	41 16 56.91080	95 42 15.66041		324.31	144757.072	315359.769	351.95	474923.83	1034642.84	1154.7

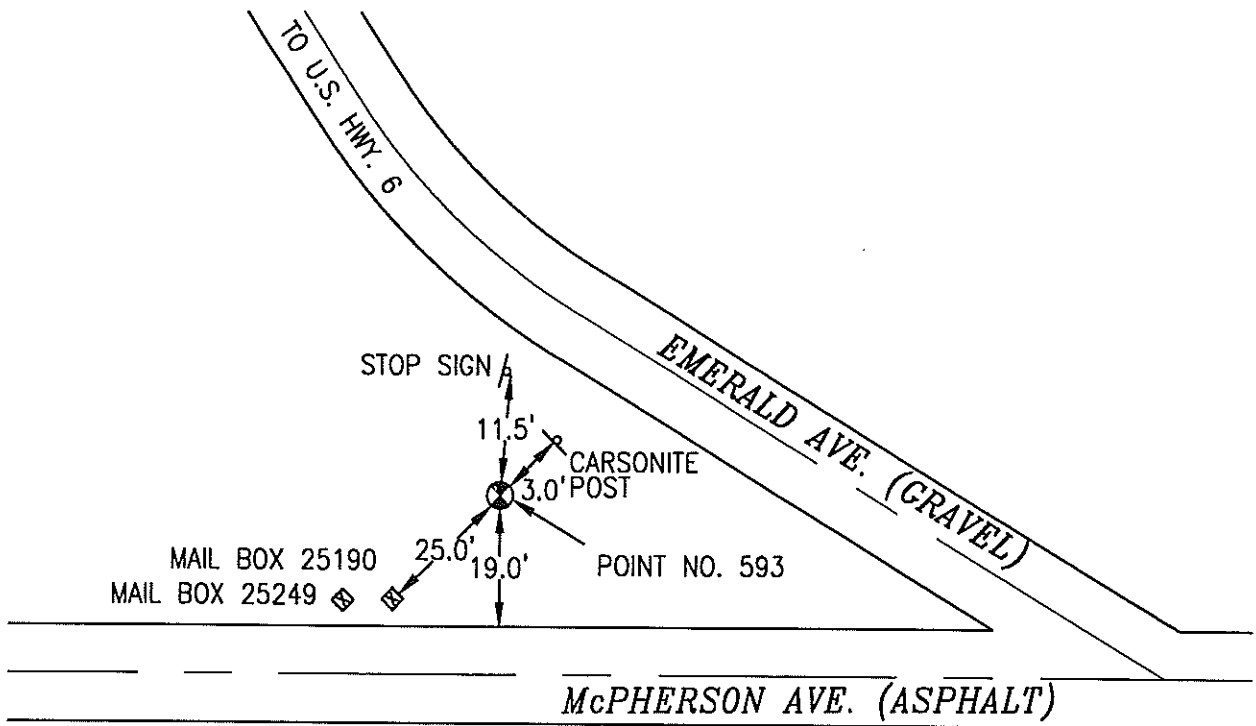

NOT TO SCALE

LOCATION DIAGRAM  
 POTTAWATTAMIE COUNTY IOWA  
 GIS Mapping Project  
 GPS Survey Report



**MERRICK**

Engineers & Architects

2450 S. Peoria Street Aurora, Colorado 80014 (303)751-0741

Job Number: 50013142

Date: November 3, 1998