

OK

609 744315-1

SET 5/8 INCH DIAMETER ROD WITH 2.5 INCH DIAMETER CAP, 0.3 FEET BELOW GROUND, STAMPED "POTTAWATTAMIE CO. 1998, 609, 744315-1". LOCATED APPROXIMATELY 22.5 FEET EAST OF THE EAST EDGE OF CHESTNUT ROAD, 47 FEET SOUTHEAST OF THE SOUTH CORNER OF A DRAINAGE STRUCTURE, 3 FEET SOUTHWEST OF A ORANGE CARSONITE POST. ON THE COUNCIL BLUFFS SOUTH 7.5 MINUTE QUADRANGLE.

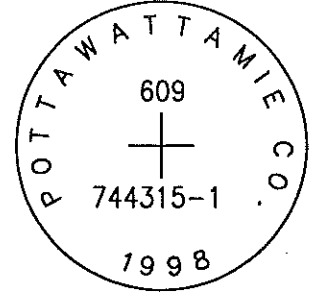

PT#	NAME OR DESIGNATION	GEODETTIC NAD83 (1996)		HEIGHT ELLIPSOID METERS	SP NAD83 (1996) IOWA SOUTH HEIGHT			SP NAD83 (1996) IOWA SOUTH HEIGHT		
		LATITUDE (North) DEG MIN SEC	LONGITUDE (West) DEG MIN SEC		NORTHING METERS	EASTING METERS	NAV88 METERS	NORTHING US FEET	EASTING US FEET	NAV88 US FEET
609	744315-1	41 12 50.93906	95 46 30.67985	286.47	137324.702	309229.077	313.94	450539.46	1014529.06	1030.0

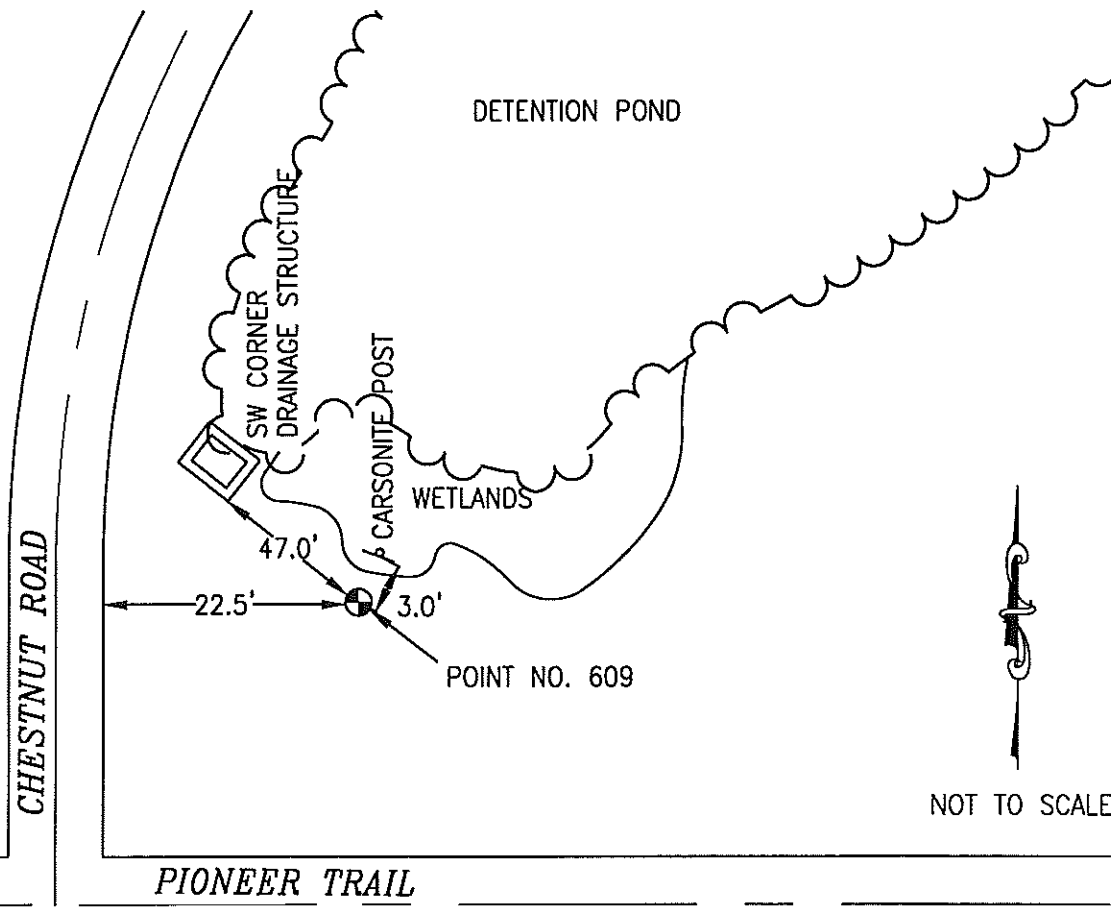

NOT TO SCALE

LOCATION DIAGRAM
 POTTAWATTAMIE COUNTY IOWA
 GIS Mapping Project
 GPS Survey Report

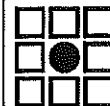

MERRICK

Engineers & Architects

2450 S. Pearl Street Aurora, Colorado 80014 (303)751-0741

Job Number: 50013142

Date: November 4, 1998