

OK out of county

623 744436-2

SET 5/8 INCH DIAMETER ROD WITH 2.5 INCH DIAMETER CAP, 0.3 FEET BELOW GROUND, STAMPED "POTTAWATTAMIE CO. 1998, 623, 744436-2". LOCATED APPROXIMATELY 60 FEET NORTH OF THE NORTH EDGE OF HIGHWAY 370, 24 FEET EAST OF THE EAST EDGE OF ALLICE ROAD, 10 FEET EAST OF UNDERGROUND CABLE SIGN, 7 FEET NORTH OF POWERPOLE. ON THE COUNCIL BLUFFS SOUTH 7.5 MINUTE QUADRANGLE.

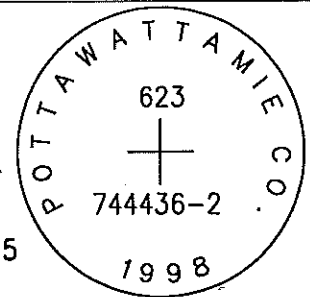

PT#	NAME OR DESIGNATION	GEODETIC NAD83 (1996)		HEIGHT ELLIPSOID METERS	SP NAD83 (1996) IOWA SOUTH HEIGHT			SP NAD83 (1996) IOWA SOUTH HEIGHT		
		LATITUDE (North) DEG MIN SEC	LONGITUDE (West) DEG MIN SEC		NORTHING METERS	EASTING METERS	NAVD88 METERS	NORTHING US FEET	EASTING US FEET	NAVD88 US FEET
623	744436-2	41 08 56.96458	95 51 20.76586	267.07	130289.632	302278.793	294.36	427458.57	991726.34	965.7

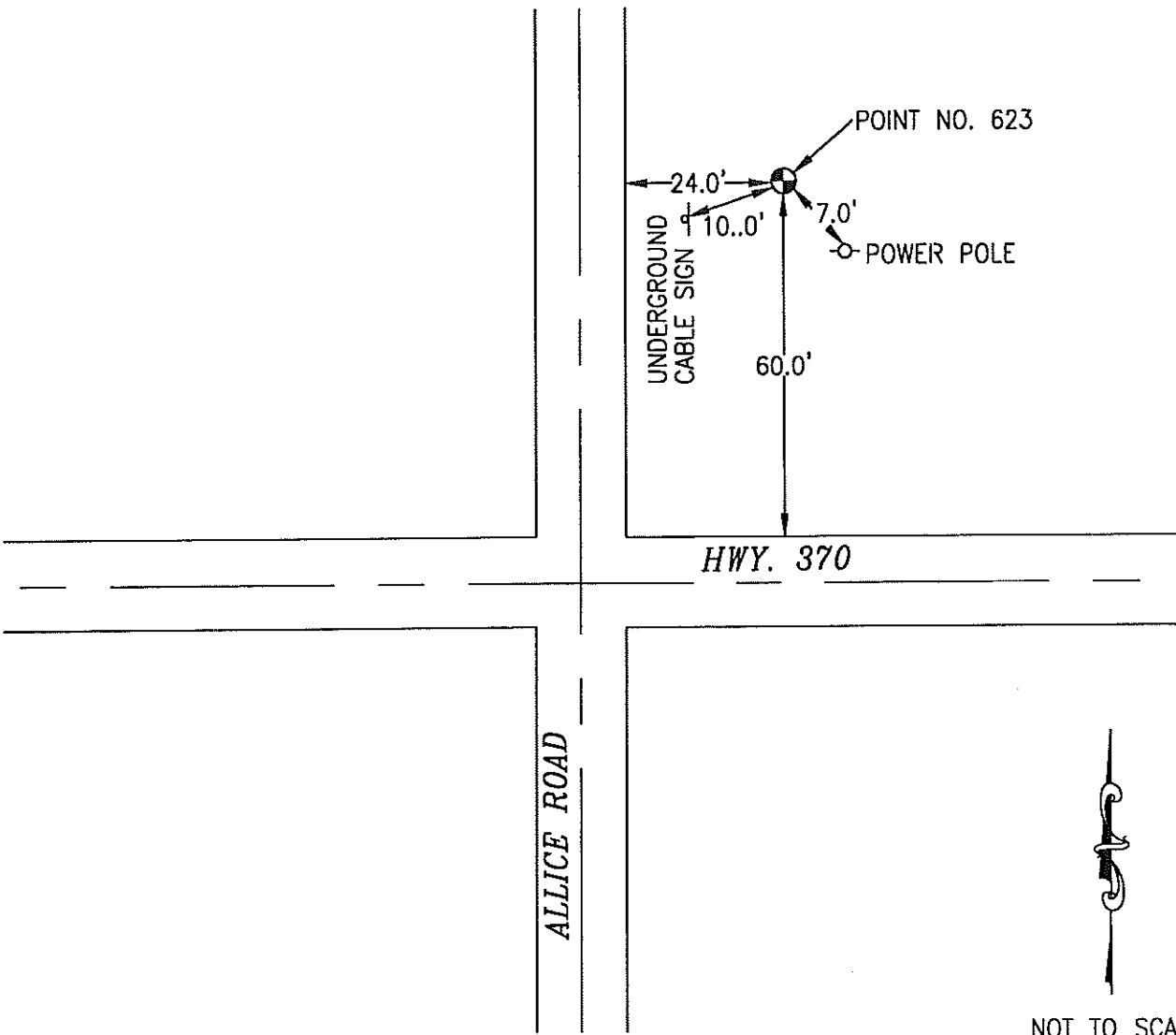

NOT TO SCALE

LOCATION DIAGRAM
 POTTAWATTAMIE COUNTY IOWA
 GIS Mapping Project
 GPS Survey Report

MERRICK
 Engineers & Architects
 2450 S. Peoria Street Aurora, Colorado 80014 (303)751-0741
 Job Number: 50013142
 Date: November 4, 1998