

ok

629 744032-3

SET 5/8 INCH DIAMETER ROD WITH 2.5 INCH DIAMETER CAP, 0.2 FEET BELOW GROUND, STAMPED "POTTAWATTAMIE CO. 1998, 629, 744032-3". LOCATED APPROXIMATELY 61 FEET EAST OF THE EAST EDGE OF 370TH STREET, 45 FEET NORTH OF THE NORTH EDGE OF APPLEWOOD ROAD, 3 FEET SOUTHWEST OF A CARSONITE POST, 27 FEET NORTHEAST OF A STOP SIGN, 29 FEET NORTHEAST OF A STREET SIGN. ON THE CARSON 7.5 MINUTE QUADRANGLE.

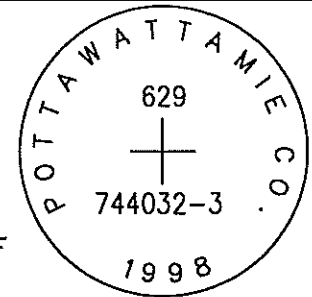

PT#	NAME OR DESIGNATION	GEODEIC NAD83 (1996)		HEIGHT ELLIPSOID METERS	SP NAD83 (1996) IOWA SOUTH HEIGHT			SP NAD83 (1996) IOWA SOUTH HEIGHT		
		LATITUDE (North) DEG MIN SEC	LONGITUDE (West) DEG MIN SEC		NORTHING METERS	EASTING METERS	NAV88 METERS	NORTHING US FEET	EASTING US FEET	NAV88 US FEET
629	744032-3	41 09 37.30699	95 28 47.96900	343.24	130747.707	333840.361	371.12	428961.44	1095274.58	1217.6

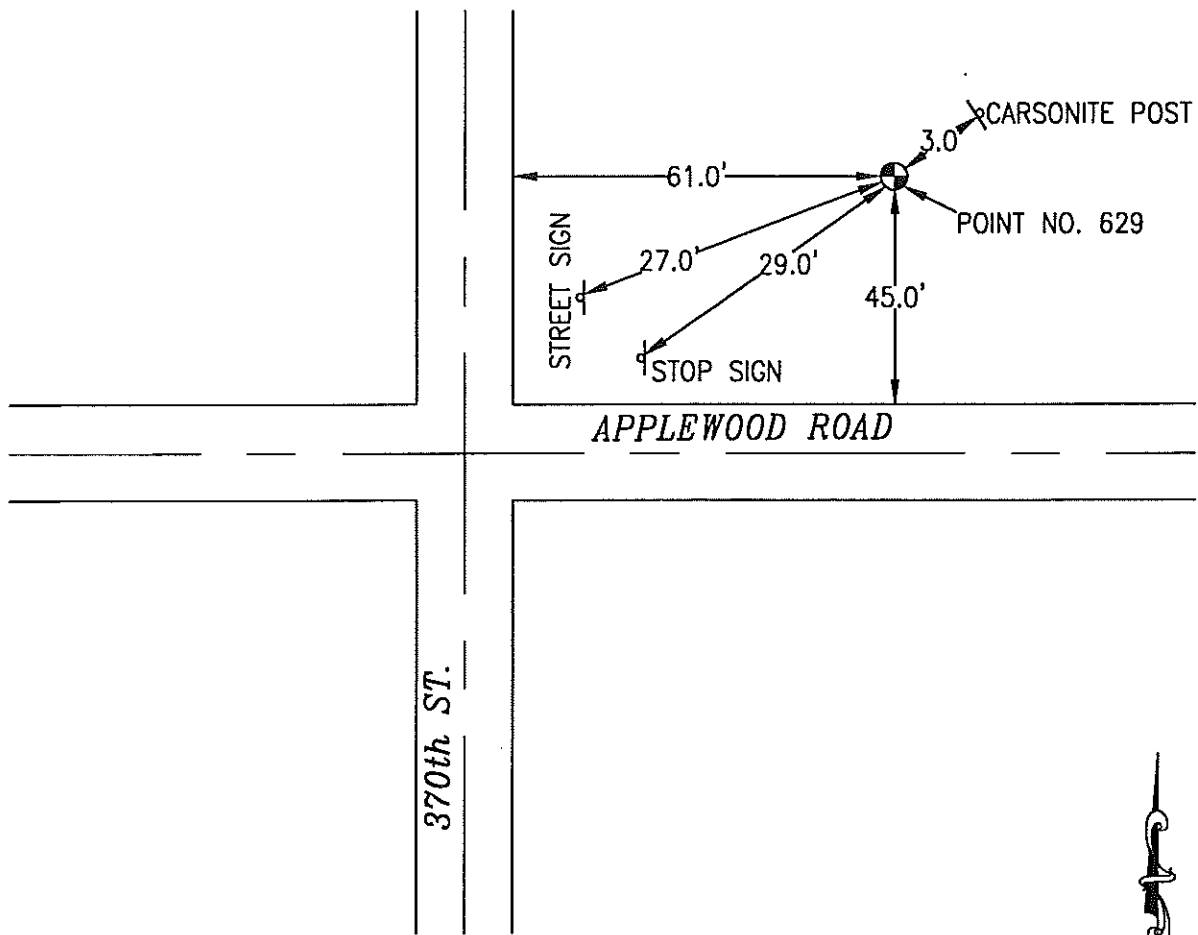

NOT TO SCALE

LOCATION DIAGRAM
POTTAWATTAMIE COUNTY IOWA
GIS Mapping Project
GPS Survey Report

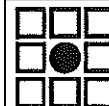

MERRICK

Engineers & Architects

2450 S. Peoria Street Aurora, Colorado 80014 (303)751-0741

Job Number: 50013142

Date: November 4, 1998