

Scott County, Iowa
Iowa South Zone (1402)
Horiz. Datum: NAD83(1996)
Vert. Datum: NAVD 1988
US Survey Feet
2005

Point Name: **1001**

Designation: GPS-1, Bettendorf GPS 2003 (Set by Howard R Green in 2003)

Northing: **601286.09sft** Easting: **2459881.27sft**

Orthometric Height: **736.88sft** Ellipsoid Height: **629.38sft** **Geoid03**

Latitude: **41°36'41.73802"N** Longitude: **90°30'09.88124"W**

Mapping Angle: **1°58'27"** Combination Scale Factor: **0.999943990**

Monument Type: Brass cap w/rebar in 2.5ft of concrete. Rebar is 3.2ft long.

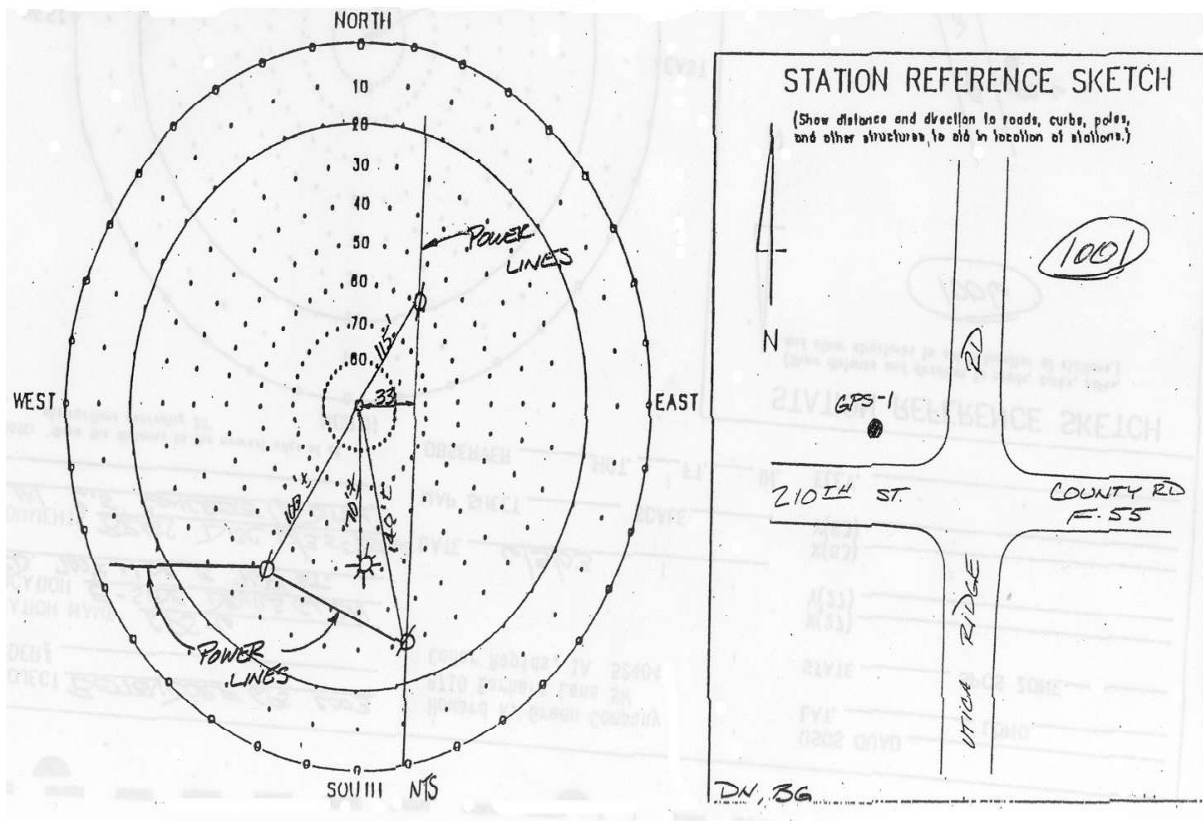

This document was prepared by DCI for use by Scott Co, Iowa.