

Scott County, Iowa
Iowa South Zone (1402)
Horiz. Datum: NAD83(1996)
Vert. Datum: NAVD 1988
US Survey Feet
2005

Point Name: **1200**

Designation: GPS-200, Bettendorf GPS 2003 (Set by Howard R Green in 2003)

Northing: **573374.30sft** Easting: **2469194.94sft**

Orthometric Height: **584.52sft** Ellipsoid Height: **477.00sft** **Geoid03**

Latitude: **41°32'02.95027"N**

Longitude: **90°28'20.13185"W**

Mapping Angle: **1°59'40"**

Combination Scale Factor: **0.999942490**

Monument Type: Set 12ft of 5/8" aluminum rod w/aluminum disc in casing w/lid.

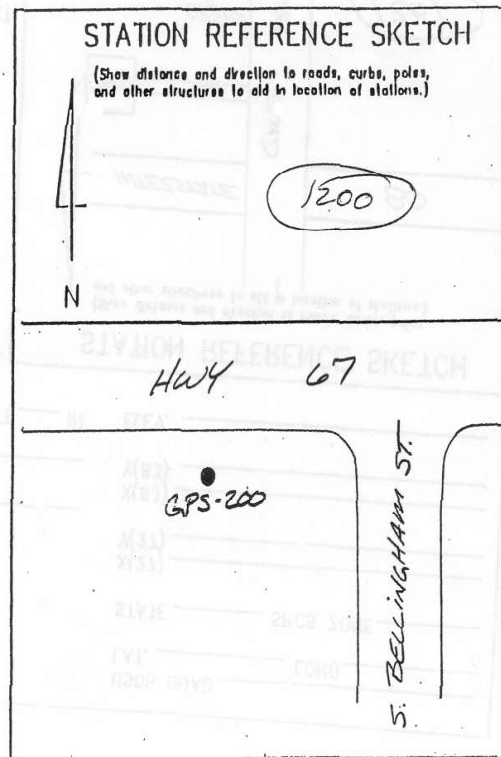
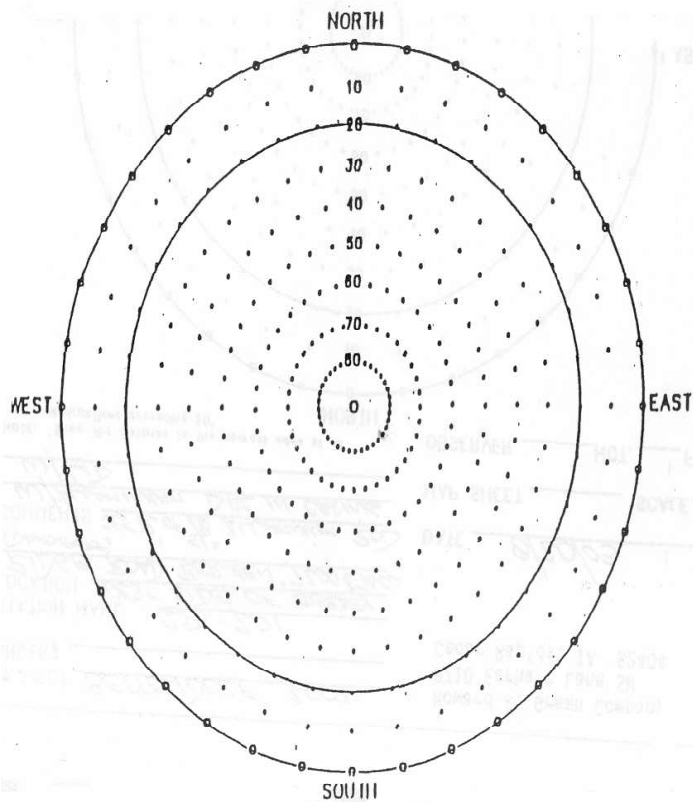

This document was prepared by DCI for use by Scott Co, Iowa.