

Scott County, Iowa
Iowa South Zone (1402)
Horiz. Datum: NAD83(1996)
Vert. Datum: NAVD 1988
US Survey Feet
2005

Point Name: **1206**

Designation: GPS-206, Bettendorf GPS 2003 (Set by Howard R Green in 2003)

Northing: **605529.02sft** Easting: **2481565.98sft**

Orthometric Height: **761.86sft** Ellipsoid Height: **654.22sft** **Geoid03**

Latitude: **41°37'16.15279"N**

Longitude: **90°25'22.61214"W**

Mapping Angle: **2°01'37"**

Combination Scale Factor: **0.999944010**

Monument Type: Set 12ft of 5/8" aluminum rod w/aluminum disc in casing w/lid.

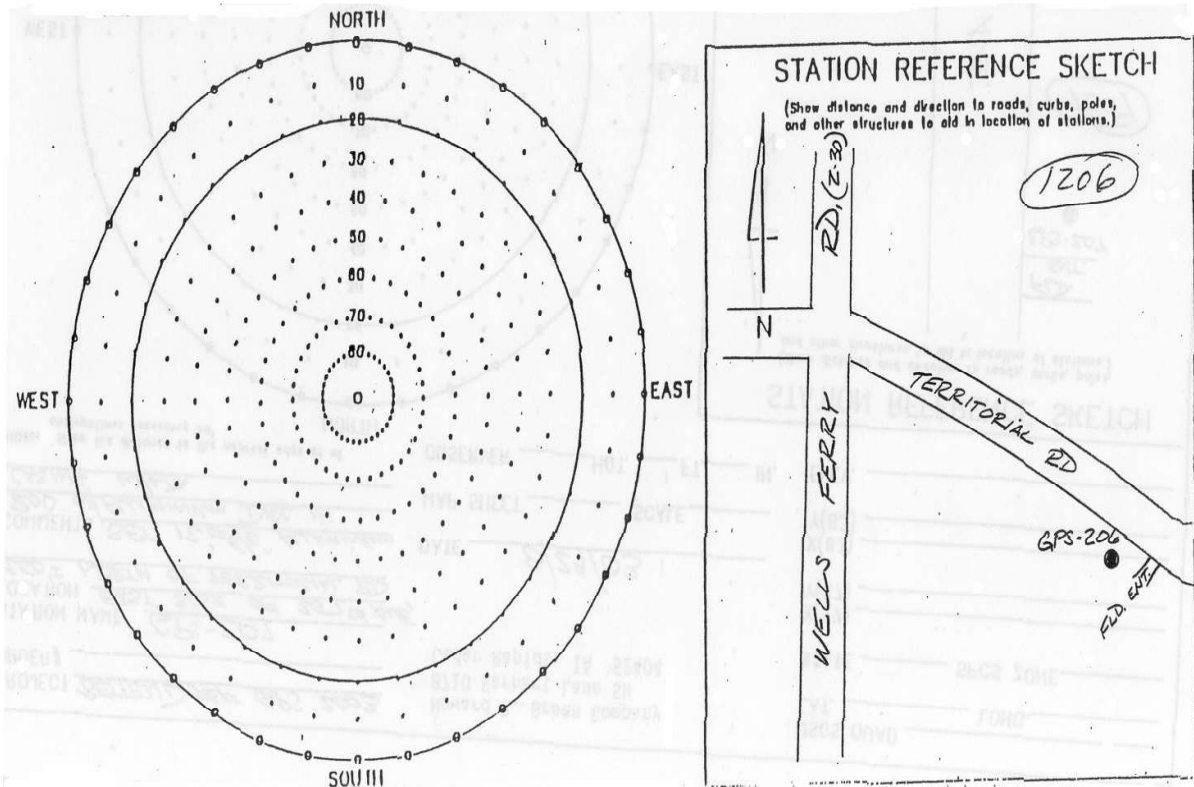

This document was prepared by DCI for use by Scott Co, Iowa.