

Scott County, Iowa
Iowa South Zone (1402)
Horiz. Datum: NAD83(1996)
Vert. Datum: NAVD 1988
US Survey Feet
2005

Point Name: **512**

Designation: CBN horizontal control station. PID: MG0753 Designation: SCHUMAKER 2

Northing: **591743.98sft** Easting: **2409696.59sft**

Orthometric Height: **760.22sft** Ellipsoid Height: **652.88sft** **Geoid03**

Latitude: **41°35'24.07162"N** Longitude: **90°41'14.26260"W**

Mapping Angle: **1°51'10"** Combination Scale Factor: **0.999940240**

Monument Type: The station is a CGS triangulation disk stamped "Schumaker 2 1958" and set in the top of a square concrete monument.

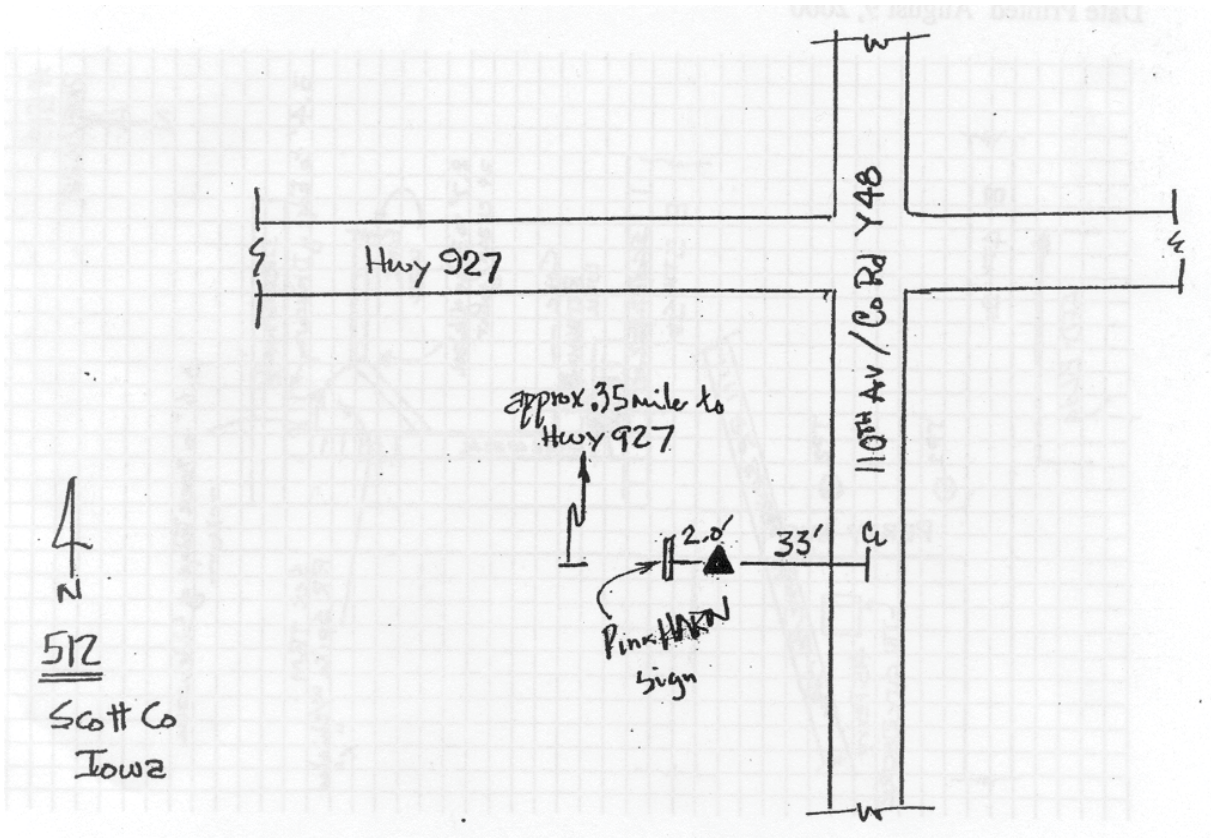

This document was prepared by DCI for use by Scott Co, Iowa.