

**SIoux COUNTY, IOWA
GPS CONTROL MONUMENT
IOWA NORTH ZONE (1401)
HORIZONTAL DATUM - NAD 83 (1996)
VERTICAL DATUM - NAVD 1988**

GPS POINT NUMBER **G123**

	US SURVEY FEET	METRIC
Northing:	3819117.595	1164069.371
Easting:	4289663.453	1307492.035
Elevation:	1413.621	430.873
Ellipsoid Height:	1325.394	403.981
Geoid 99 Height:	-88.227	-26.892

Latitude:	42° 57' 10.36740" N
Longitude:	95° 51' 34.12195" W
Scale Factor:	0.9999577331
Convergence:	-1° 35' 56.8"
Combined Factor:	0.99989450

Description:

Placed 3/4" X 6' - 0" Long Aluminum Rod with Cap Stamped G123 and NGS Style Access Cover 2" Deep

Location:

Northwest side of intersection of McKinley Avenue and 480th Street east county line in Section 13, T94N, R43W.

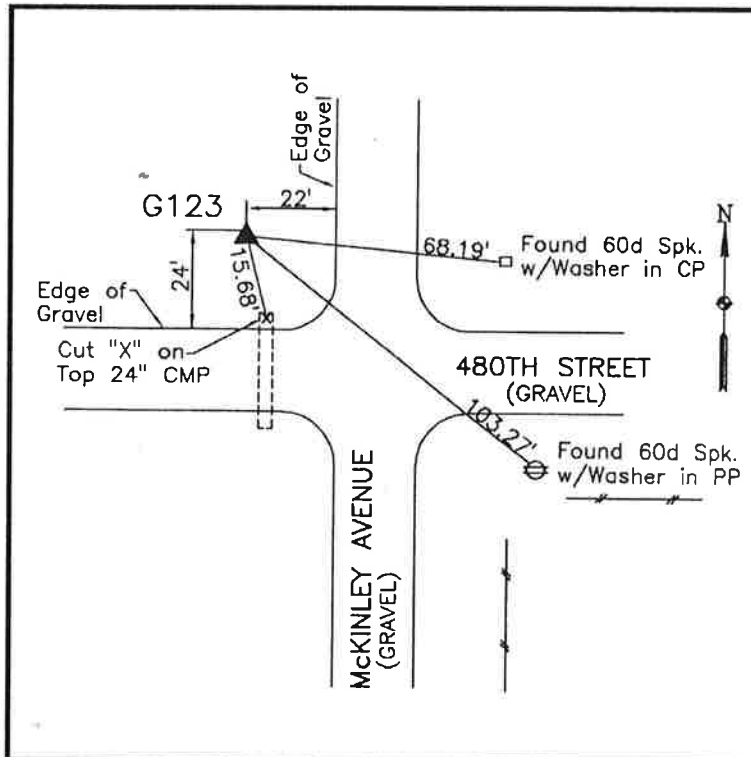

WHKS & CO.