

2000  
Tama Indian Settlement, Tama, Iowa  
Iowa North Zone (1401)  
NAD\_83(1996)

Point Number: 7

Northing: 3463897.47(Ft)      Easting: 5139177.06(Ft)

Northing: 1055798.060(M)      Easting: 1566424.302(M)

Elev: 861.70(Ft) NAVD\_88

Elev: 262.645(M) NAVD\_88      Ellip Ht: 231.008(M)      96C Geoid Ht: -31.637(M)

Latitude: 41-59-58.206739 N      Longitude: 92-41-53.772699 W

Theta: 0-32-36.12      Combination Factor: 0.99997662

Designation: GPS CONTROL PT 2000-007

**Monument Type:** 5/8" dia driven aluminum rod with a 2-1/2" dia aluminum cap and permanent magnet encased in a 5" dia PVC pipe with an aluminum access cover.

**To Reach:** 61ft S of Hwy 30, 63ft E of "E" Ave in Sec 15 T83N R16W.

Date Printed July 19, 2000

4  
N

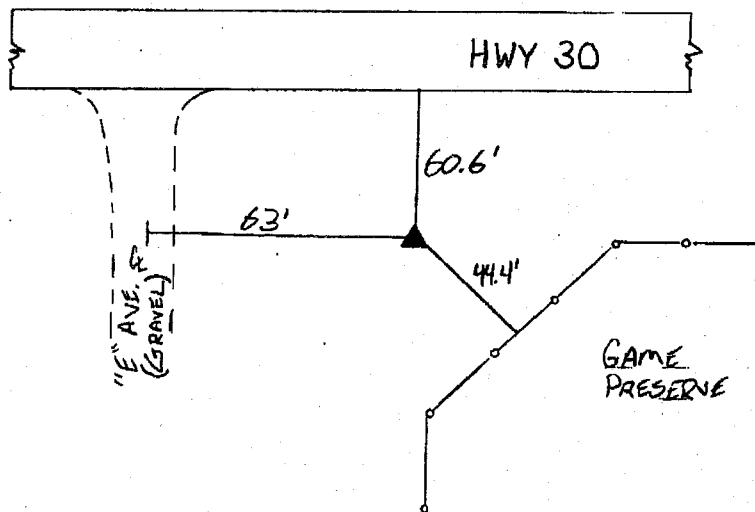

007  
DBL/JJR  
3-29-00