

Tama County, Iowa
Iowa North Zone (1401)
Horiz. Datum: NAD83(NSRS2007)
Vert. Datum: NAVD 1988
US Survey Feet
2007

Point Name: **1001**

Designation: FBN horizontal and 2nd order vertical control station "D 88" PID: MH0163

Northing: **3408688.14**sft Easting: **5116608.57**sft

Orthometric Height: **1030.41**sft Ellipsoid Height: **925.97**sft **Geoid03**

Latitude: **41°50'54.83235"N**

Longitude: **92°46'58.85597"W**

Mapping Angle: **0°29'09"**

Combination Scale Factor: **1.00000255**

Monument Type: The station mark is a CGS bench mark disk stamped "D 88 1934" and set in the top of a concrete monument.

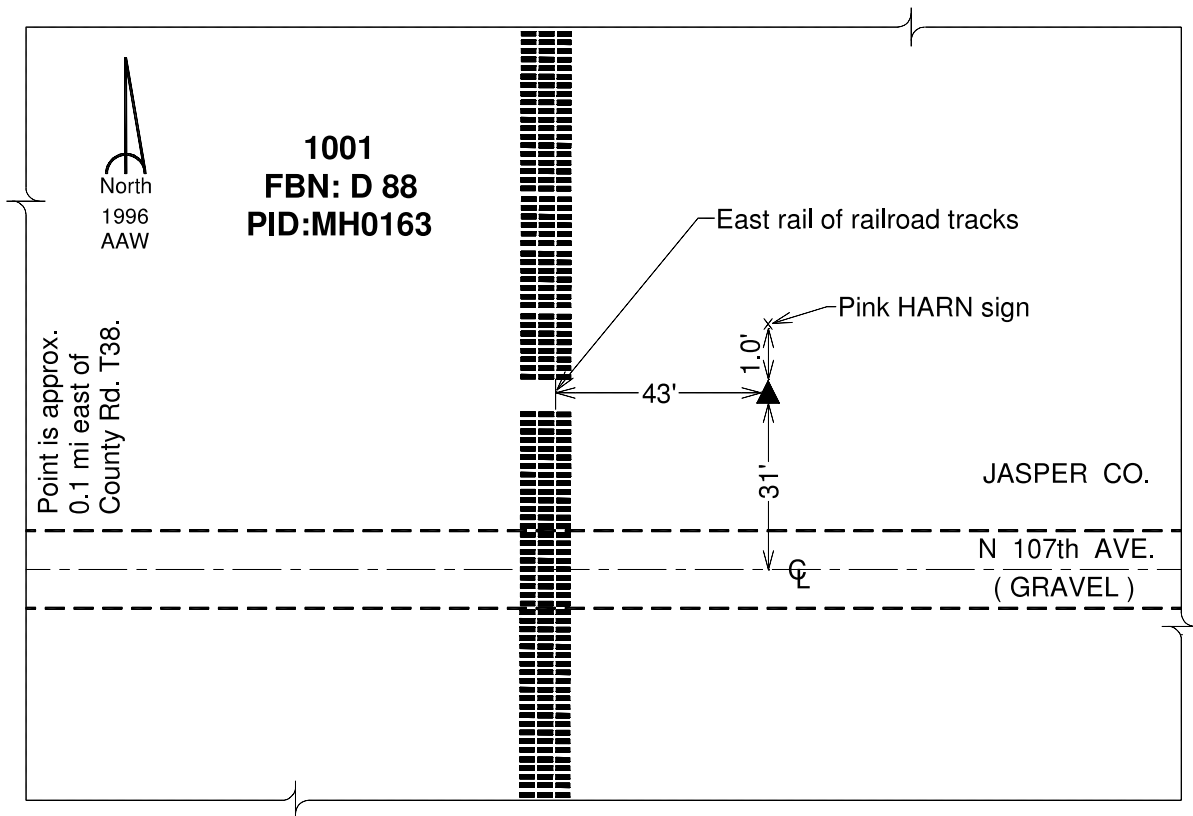

This document was prepared by DCI and GBC for use by Tama County, Iowa.