

**Tama County, Iowa**  
Iowa North Zone (1401)  
Horiz. Datum: NAD83(NSRS2007)  
Vert. Datum: NAVD 1988  
US Survey Feet  
**2007**

Point Name: **1012**

**Designation:** CBN horizontal control station "BROOK" PID: NK0611

Northing: **3524878.54**sft Easting: **5141087.30**sft

Orthometric Height: **1040.77**sft Ellipsoid Height: **936.69**sft **Geoid03**

Latitude: **42°10'00.41830"N**

Longitude: **92°41'20.72838"W**

Mapping Angle: **0°32'59"**

Combination Scale Factor: **0.99993864**

**Monument Type:** The station mark is a USGS traverse station disk stamped "ET BROOK 1970" crimped on a copper-clad steel rod and set in a 6" clay tile.

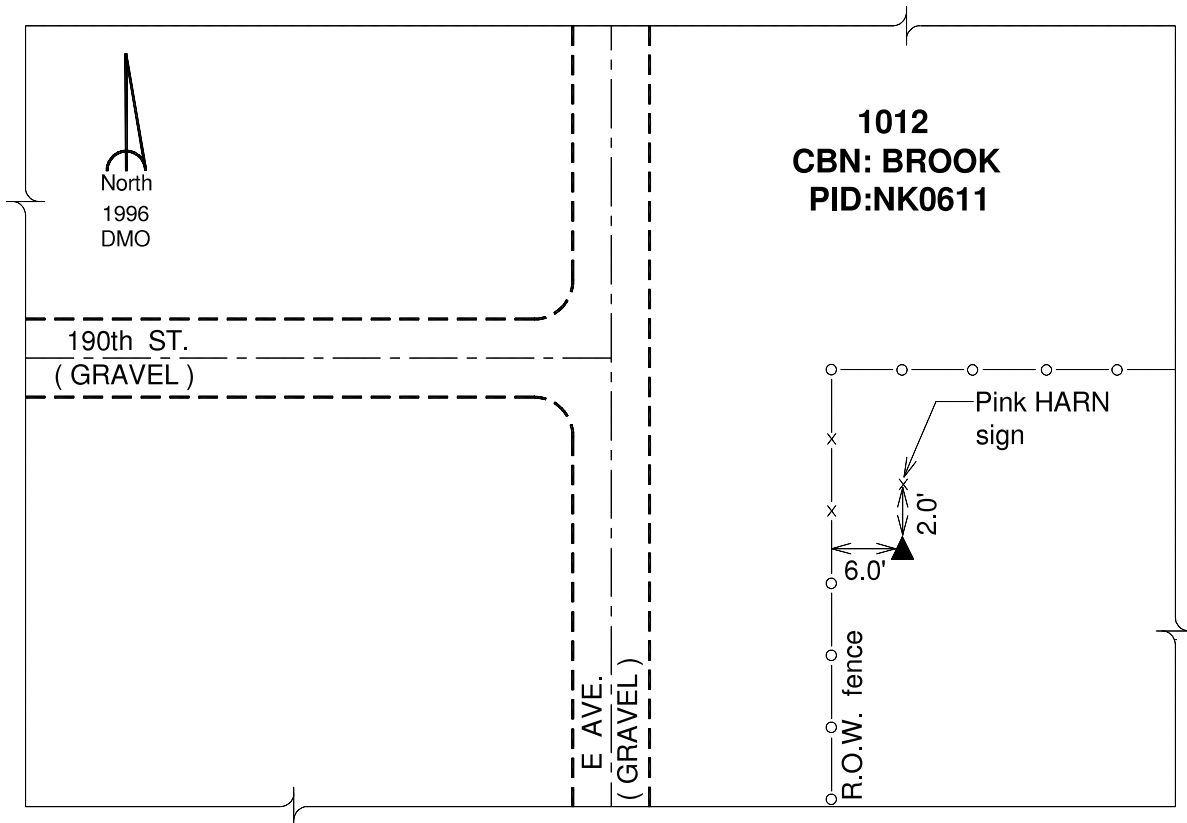

*This document was prepared by DCI and GBC for use by Tama County, Iowa.*