

Tama County, Iowa
Iowa North Zone (1401)
Horiz. Datum: NAD83(NSRS2007)
Vert. Datum: NAVD 1988
US Survey Feet
2007

Point Name: **1035**

Designation: 2003-007 BENTON CO (set by DCI in 2003)

Northing: **3526173.18**sft Easting: **5247211.83**sft

Orthometric Height: **945.96**sft Ellipsoid Height: **843.25**sft **Geoid03**

Latitude: **42°10'00.72352"N** Longitude: **92°17'51.39023"W**

Mapping Angle: **0°48'54"** Combination Scale Factor: **0.99994309**

Monument Type: Berntsen Top Security Rod Monument with a 2-1/2" dia. domed survey cap and permanent magnet encased in a 5" dia. PVC pipe with a NGS style aluminum access cover.

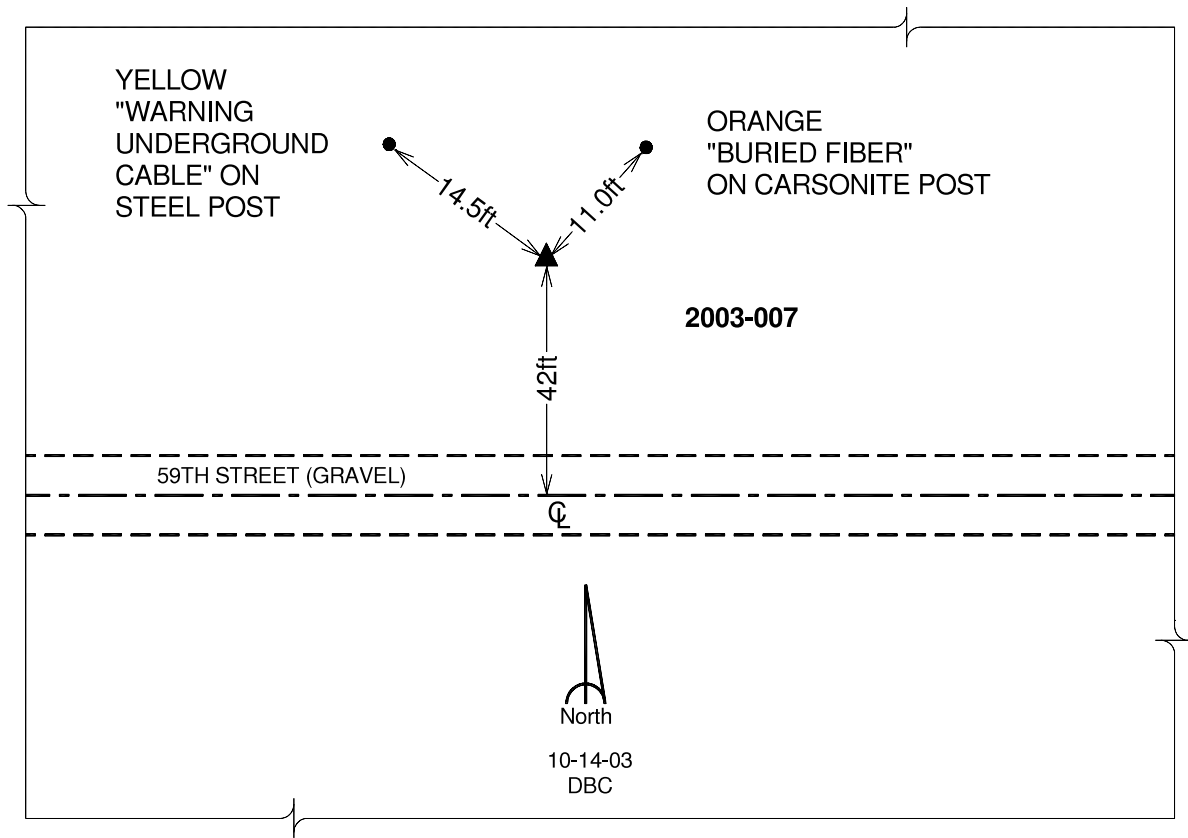

This document was prepared by DCI and GBC for use by Tama County, Iowa.