

Tama County, Iowa
Iowa North Zone (1401)
Horiz. Datum: NAD83(NSRS2007)
Vert. Datum: NAVD 1988
US Survey Feet
2007

Point Name: **1045**

Designation: CBN horizontal control station "PRATT" PID: NK0557

Northing: **3542469.93**sft Easting: **5270220.03**sft

Orthometric Height: **978.31**sft Ellipsoid Height: **876.24**sft **Geoid03**

Latitude: **42°12'38.34997"N** Longitude: **92°12'42.60121"W**

Mapping Angle: **0°52'23"** Combination Scale Factor: **0.99993517**

Monument Type: The station mark is a USGS traverse station disk stamped "ET PRATT 1970" crimped on a copper-clad steel rod and set in a 6" clay tile.

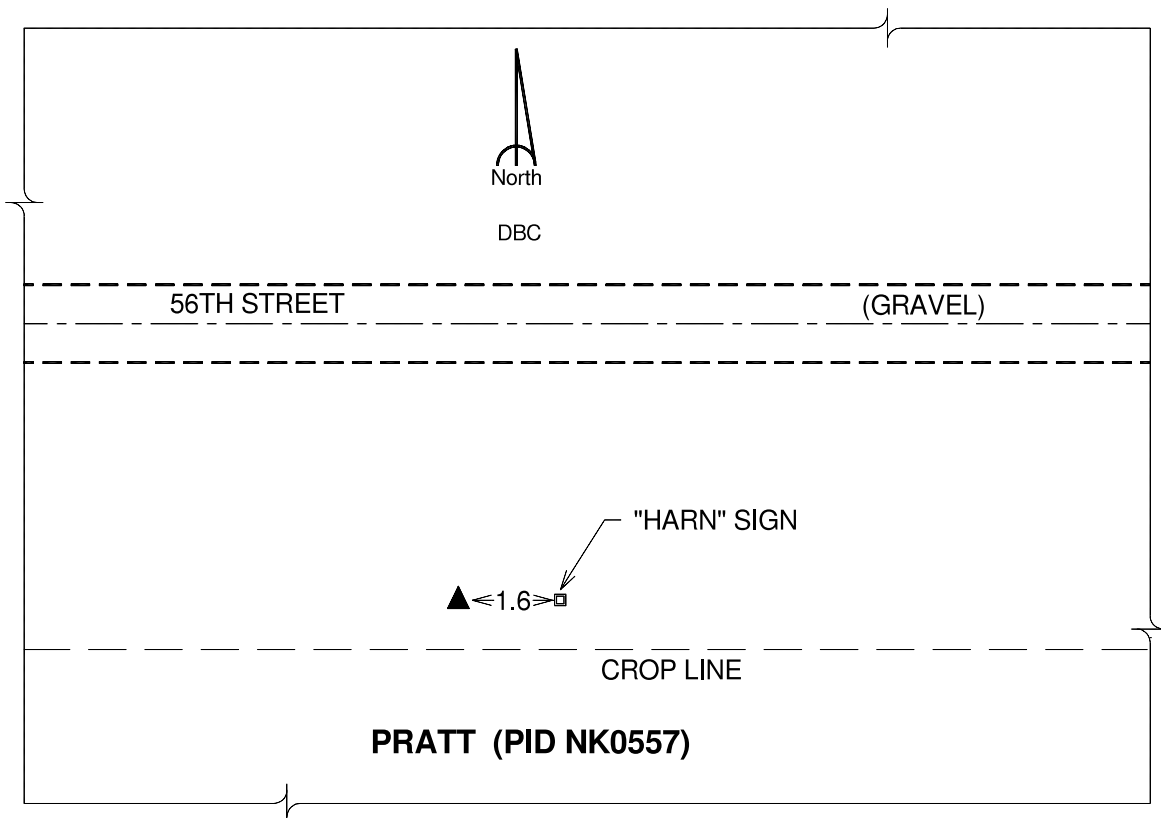

This document was prepared by DCI and GBC for use by Tama County, Iowa.