

**Tama County, Iowa**  
Iowa North Zone (1401)  
Horiz. Datum: NAD83(NSRS2007)  
Vert. Datum: NAVD 1988  
US Survey Feet  
**2007**

Point Name: **3**

**Designation:** 2007-003 Tama Co GPS Control Pt

Northing: **3445336.63**sft Easting: **5136844.71**sft

Orthometric Height: **861.44**sft Ellipsoid Height: **757.23**sft **Geoid03**

Latitude: **41°56'55.07388"N** Longitude: **92°42'26.96497"W**

Mapping Angle: **0°32'14"** Combination Scale Factor: **0.99998739**

**Monument Type:** Berntsen 3/4" Top Security Rod Monument with a 2-1/2" dia. domed survey cap and permanent magnet encased in a white PVC pipe with a NGS style alum. access cover.

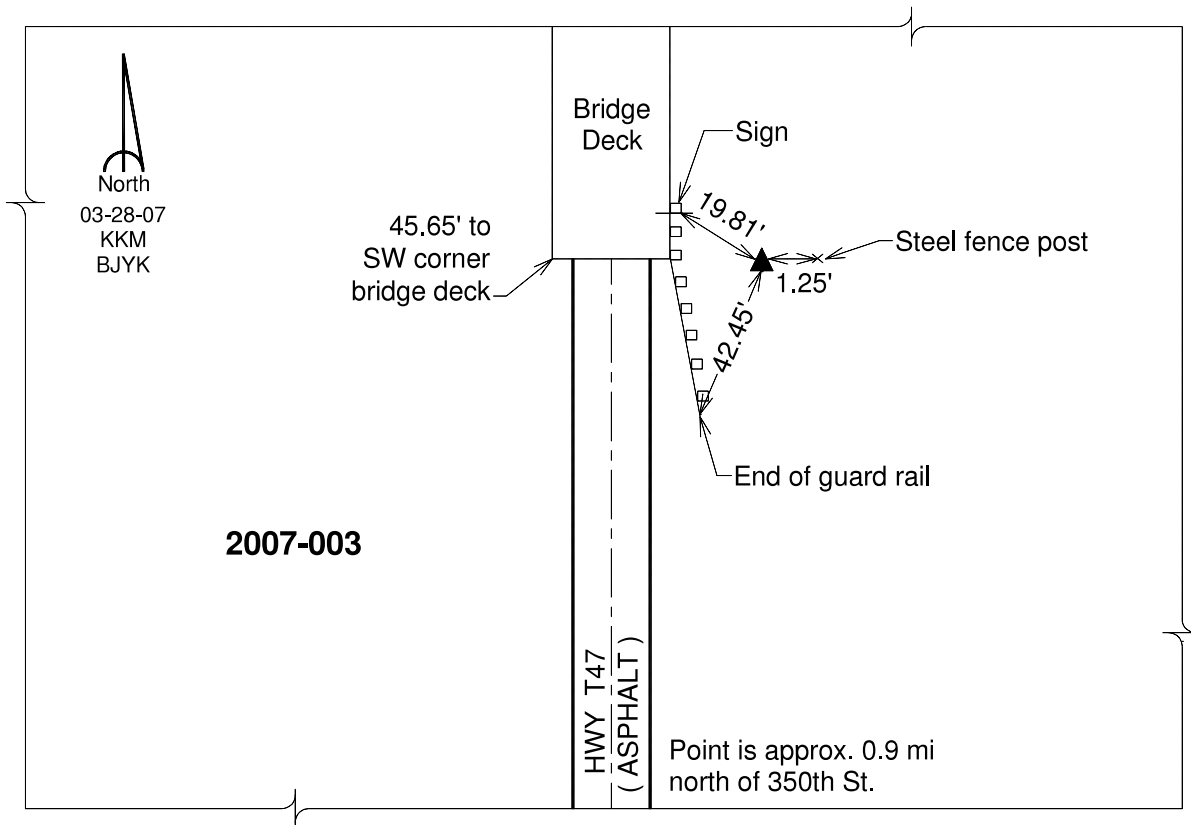

*This document was prepared by DCI and GBC for use by Tama County, Iowa.*