

**Tama County, Iowa**  
 Iowa North Zone (1401)  
 Horiz. Datum: NAD83(NSRS2007)  
 Vert. Datum: NAVD 1988  
 US Survey Feet  
**2007**

Point Name: **40**

**Designation:** 2007-040 Tama Co GPS Control Pt

Northing: **3556965.38**sft Easting: **5181691.46**sft

Orthometric Height: **967.65**sft Ellipsoid Height: **864.04**sft **Geoid03**

Latitude: **42°15'13.17336"N** Longitude: **92°32'16.73041"W**

Mapping Angle: **0°39'07"** Combination Scale Factor: **0.99993009**

**Monument Type:** Berntsen 3/4" Top Security Rod Monument with a 2-1/2" dia. domed survey cap and permanent magnet encased in a white PVC pipe with a NGS style alum. access cover.

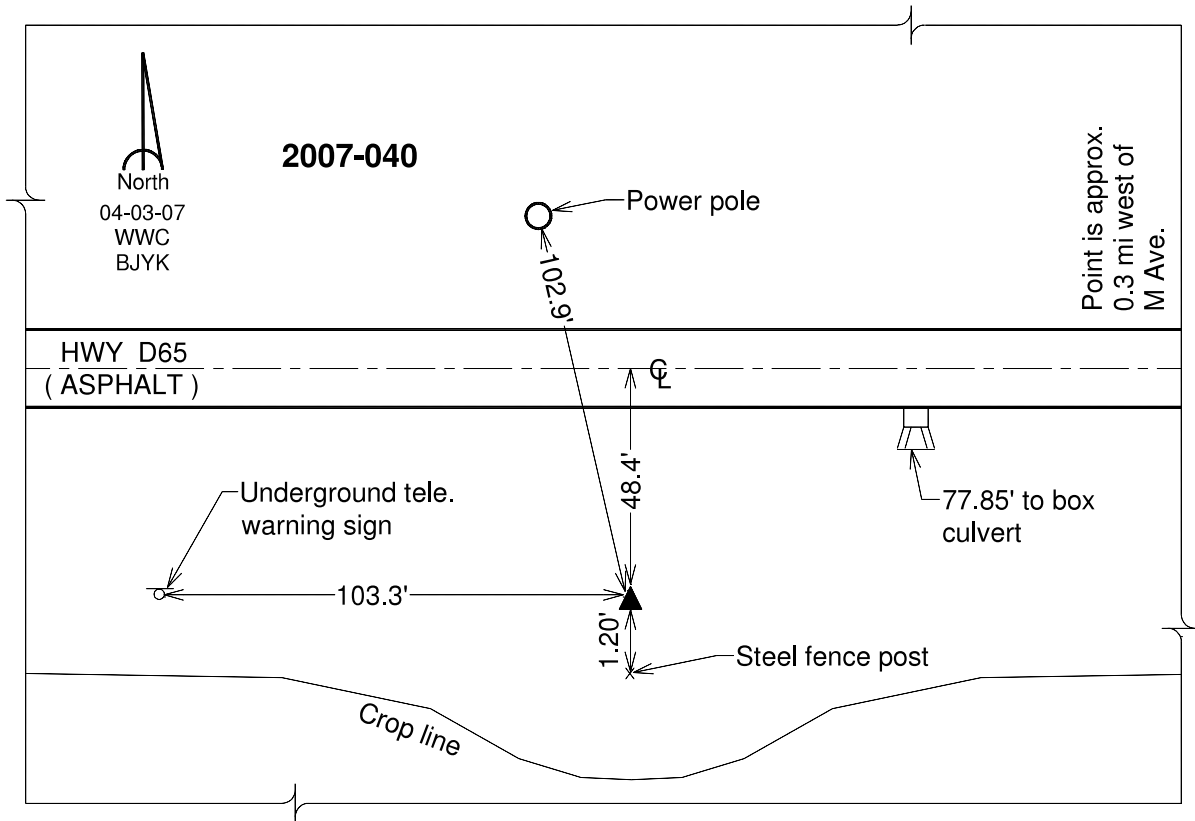

*This document was prepared by DCI and GBC for use by Tama County, Iowa.*