

Tama County, Iowa
Iowa North Zone (1401)
Horiz. Datum: NAD83(NSRS2007)
Vert. Datum: NAVD 1988
US Survey Feet
2007

Point Name: **521**

Designation: NGS 2nd order vertical control station "TRAER" PID: NK0060

Northing: **3534151.42**sft Easting: **5201843.61**sft

Orthometric Height: **962.84**sft Ellipsoid Height: **859.89**sft **Geoid03**

Latitude: **42°11'25.46359"N**

Longitude: **92°27'52.49483"W**

Mapping Angle: **0°42'06"**

Combination Scale Factor: **0.99993881**

Monument Type: The station mark is a CGS bench mark disk stamped "TRAER 1934" and set in the top of a concrete monument.

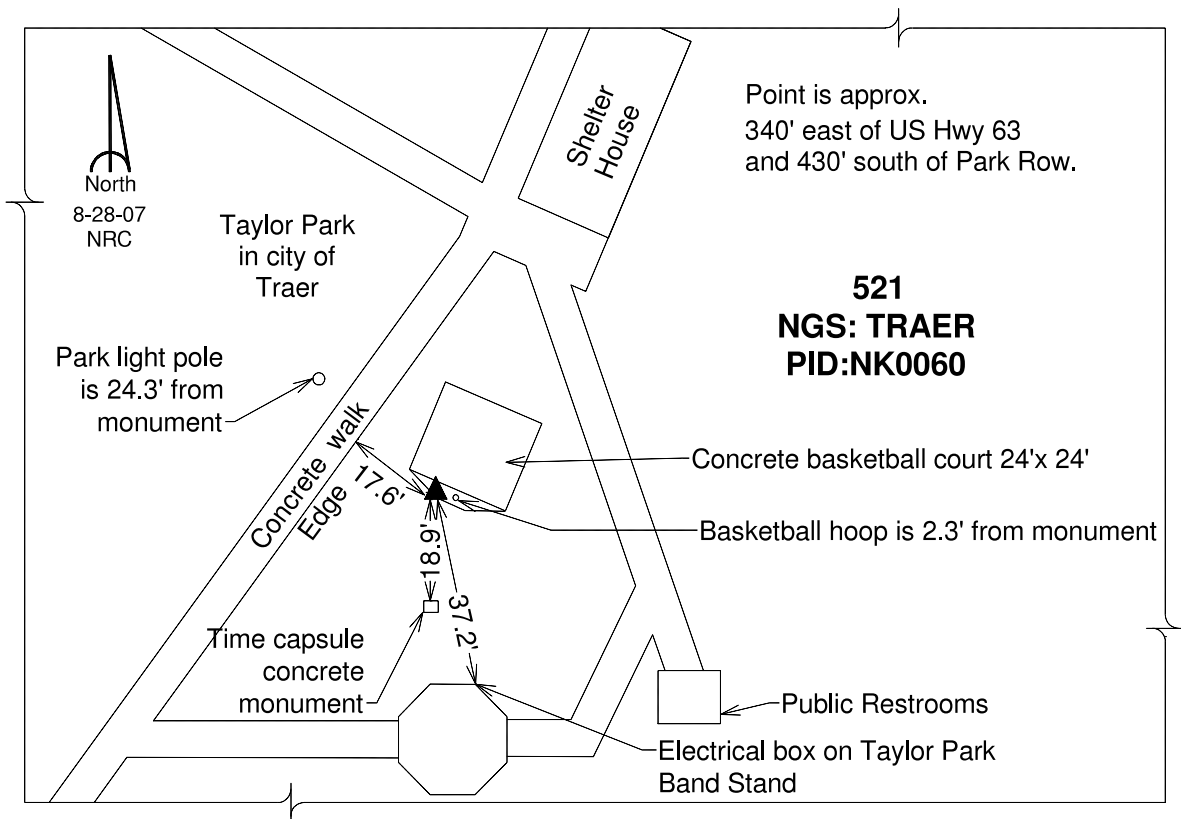

This document was prepared by DCI and GBC for use by Tama County, Iowa.