

**Taylor County, Iowa**  
Iowa South Zone (1402)  
Horiz. Datum: **NAD83(NA2011)**  
Vert. Datum: NAVD 1988  
US Survey Feet  
**2013**

Point Name: **1009**

**Designation:** 2009-009 Taylor Co GPS Control Pt (Set by DCI in 2009)

Northing: **313623.60**sft    Easting: **1329506.27**sft

Orthometric Height: **1267.66**sft    Ellipsoid Height: **1166.18**sft                      **Geoid12A**

Latitude: **N40°51'19.10854"**                      Longitude: **W94°37'26.27372"**

Mapping Angle: **-0°44'25"**                      Combination Scale Factor: **0.999910812**

**Monument Type:** Berntsen 3/4" Top Security Rod Monument with a 2-1/2" dia. domed survey cap and permanent magnet encased in a white PVC pipe with a NGS style alum. access cover.

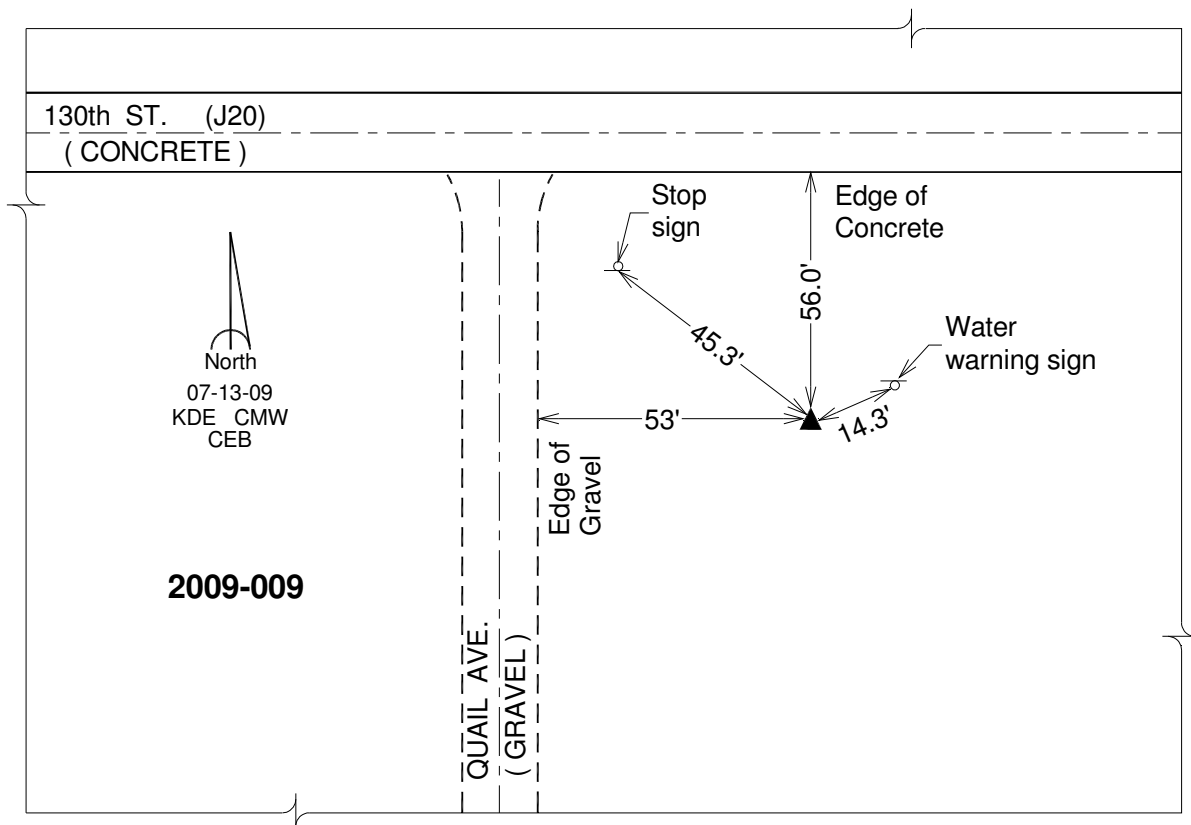

*This document was prepared by DCI on 04-17-2013 for use by Taylor County, Iowa.*