

1996
Washington County, Iowa
Iowa South Zone(1402)
NAD_83

Point Number: 027

Northing: 539050.49(Ft) Easting: 2099589.85(Ft)

Northing: 164302.919(M) Easting: 639956.266(M)

Elev: 738.25(Ft) NAVD_88

Elev: 225.019(M) NAVD_88 Ellip Ht: 192.572(M) 93C Geoid Ht: -32.447(M)

Latitude: 41-28-02.658168 Longitude: 91-49-28.084390

Theta: 1-06-13.23 Combination Factor: 0.99992894

Designation: 96-027 WASHINGTON CO. GPS CONTROL PT

Monument Type: 5/8" dia driven aluminum rod with 2 1/2" dia aluminum cap and permanent magnet encased in a 5" dia PVC pipe with aluminum access cover.

To Reach: 46 ft. North of Hwy 22, 70 ft. West of entrance to Mid Prairie H.S. on East side of Wellman.
In the S.W. corner of Sec 18, T77N, R9W.

Date Printed: 11/25/96

Set NGS style
Rod Monument
With Access Cover

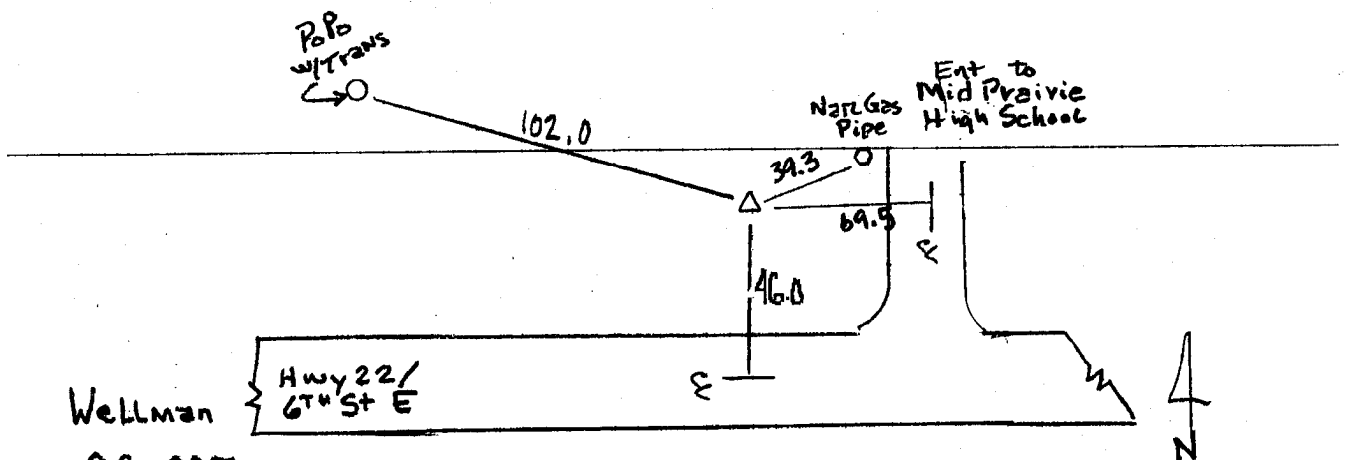

96-027
RKE KRR