

1996
Washington County, Iowa
Iowa South Zone(1402)
NAD_83

Point Number: **108**

Northing: **532868.33(Ft)** Easting: **2066304.63(Ft)**

Northing: **162418.591(M)** Easting: **629810.911(M)**

Elev: **775.38(Ft)** NAVD_88

Elev: **236.335(M)** NAVD_88 Ellip Ht: **203.958(M)** 93C Geoid Ht: **-32.377(M)**

Latitude: **41-27-07.691572** Longitude: **91-56-46.688548**

Theta: **1-01-24.32** Combination Factor: **0.99992596**

Designation: **96-108 WASHINGTON CO. GPS CONTROL PT**

Monument Type: **5/8" dia driven aluminum rod with 2 1/2" dia aluminum cap and permanent magnet encased in a 5" dia PVC pipe with aluminum access cover.**

To Reach: **20 ft. West of Keokuk-Washington Rd, 58 ft. South of field entrance to West. Near the N.E. corner of Sec 25, T77N, R10W.**

Date Printed: 11/25/96

Set NGS Style
Rod Monument
With Access Cover

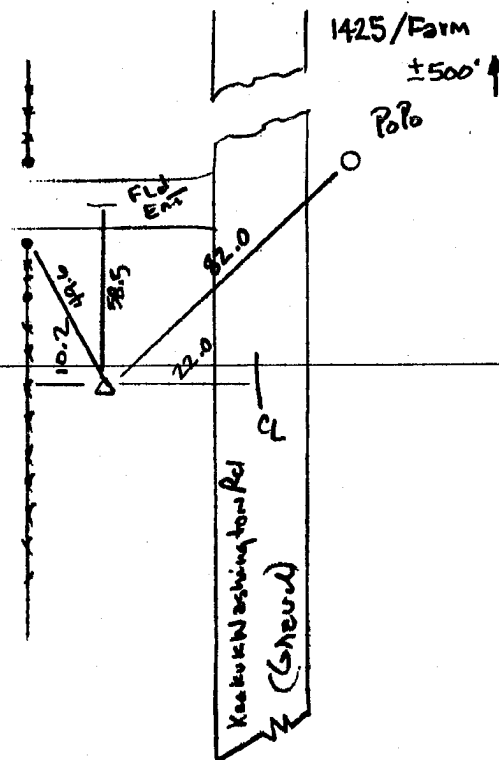

108
RKE KRR