

1996  
Washington County, Iowa  
Iowa South Zone(1402)  
NAD\_83

Point Number: 127

Northing: 503813.68(Ft) Easting: 2193620.24(Ft)

Northing: 153562.715(M) Easting: 668616.785(M)

Elev: 697.74(Ft) NAVD\_88

Elev: 212.671(M) NAVD\_88 Ellip Ht: 180.043(M) 93C Geoid Ht: -32.628(M)

Latitude: 41-21-54.873223 Longitude: 91-29-03.986051

Theta: 1-19-39.54 Combination Factor: 0.99992422

Designation: 96-127 WASHINGTON CO. GPS CONTROL PT

Monument Type: 5/8" dia driven aluminum rod with 2 1/2" dia aluminum cap and permanent magnet encased in a 5" dia PVC pipe with aluminum access cover.

To Reach: 25 ft. West of Louisa-Washington Rd., 10 ft. North of field entrance to East. Near the S.E. corner of Sec 24, T76N, R6W.

Date Printed: 11/25/96

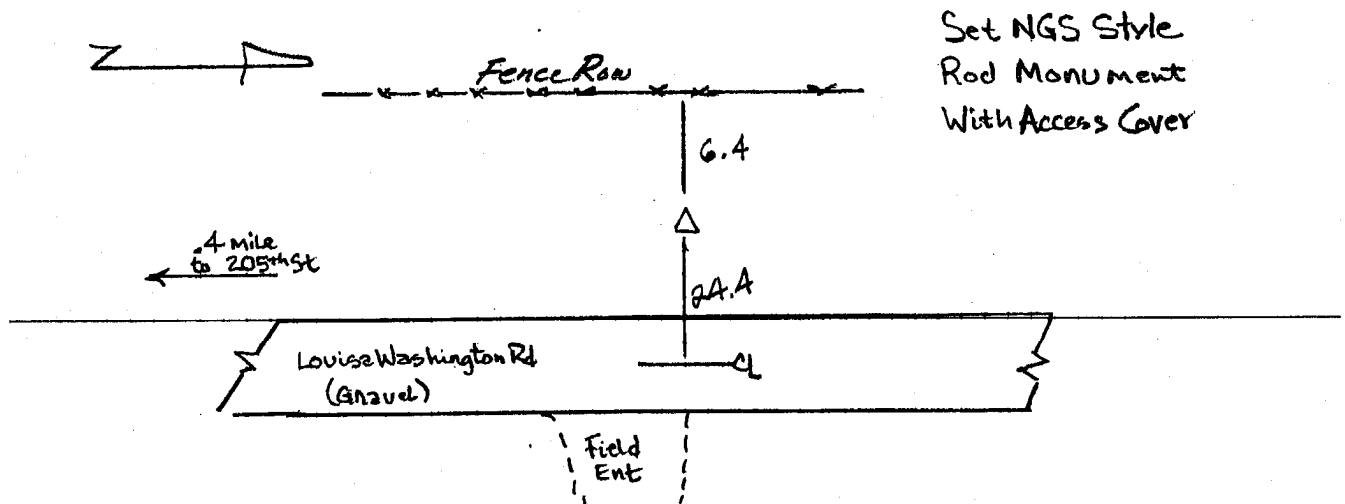

127  
RKE KRR