

1996
Washington County, Iowa
Iowa South Zone(1402)
NAD_83

Point Number: 136

Northing: 482490.92(Ft) Easting: 2151579.14(Ft)

Northing: 147063.526(M) Easting: 655802.632(M)

Elev: 738.25(Ft) NAVD_88

Elev: 225.019(M) NAVD_88 Ellip Ht: 192.355(M) 93C Geoid Ht: -32.664(M)

Latitude: 41-18-33.500301 Longitude: 91-38-21.218764

Theta: 1-13-32.49 Combination Factor: 0.99991997

Designation: 96-136 WASHINGTON CO. GPS CONTROL PT

Monument Type: 5/8" dia driven aluminum rod with 2 1/2" dia aluminum cap and permanent magnet encased in a 5" dia PVC pipe with aluminum access cover.

To Reach: 40 ft. East of Quince Av., 40 ft. North of 240th St. Near the S.W. corner of Sec 11, T75N, R7W.

Date Printed: 11/25/96

Set NGS Style
Rod Monument
With Access Cover

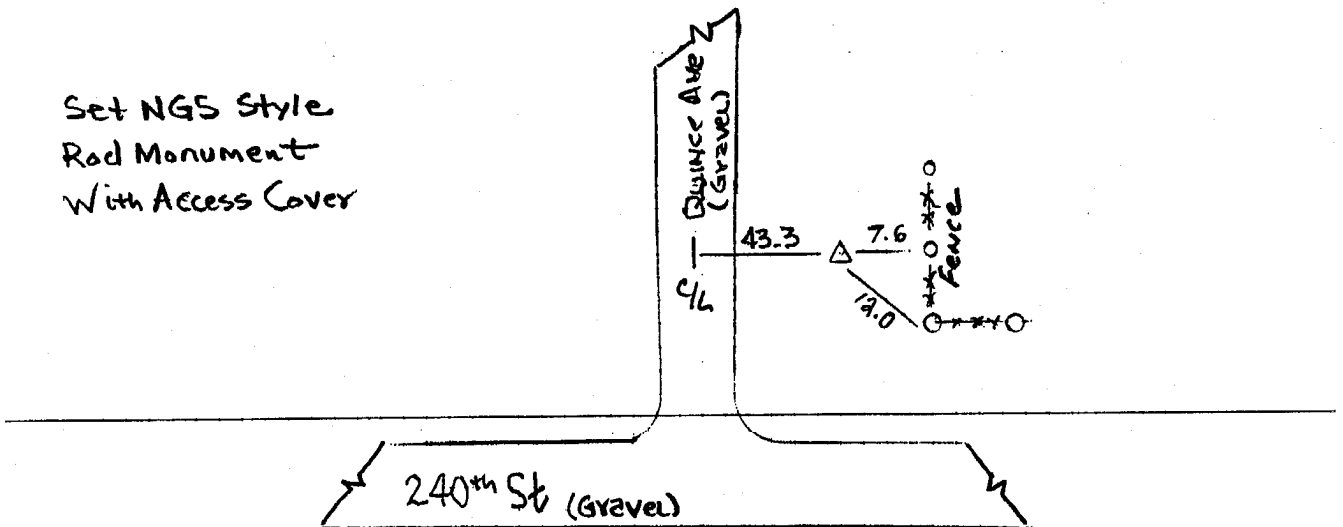

136
RKE KRR

