

Wayne County, Iowa
 Iowa South Zone (1402)
 Horiz. Datum: NAD83(NSRS2007)
 Vert. Datum: NAVD 1988
 US Survey Feet
2007

Point Name: **37**

Designation: 8066 Appanoose Co (set by Deni Associates, Inc. in 1998)

Northing: **216808.31**sft Easting: **1752272.36**sft

Orthometric Height: **1047.79**sft Ellipsoid Height: **943.46**sft **Geoid03**

Latitude: **40°35'39.74155"N**

Longitude: **93°05'50.04309"W**

Mapping Angle: **0°15'55"**

Combination Scale Factor: **0.99995899**

Monument Type: The station mark is a 3-1/4" aluminum disk set in a 10" diameter poured-in-place concrete monument.

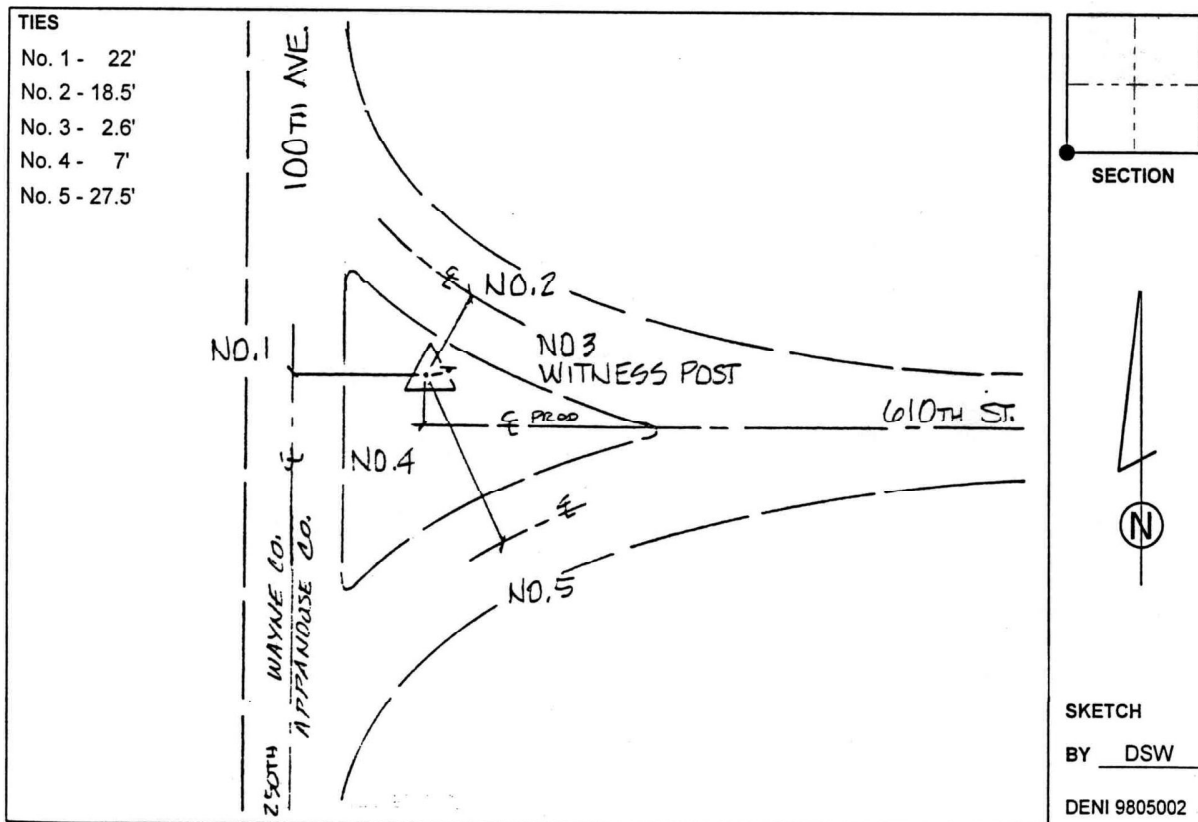

This document was prepared by DCI and GBC for use by Wayne County, Iowa.