

**Wayne County, Iowa**  
Iowa South Zone (1402)  
Horiz. Datum: NAD83(NSRS2007)  
Vert. Datum: NAVD 1988  
US Survey Feet  
**2007**

Point Name: **6002**

**Designation:** FBN horizontal and 1st order vertical control station "X 7" PID:LE0188

Northing: **229889.42**sft Easting: **1801850.39**sft

Orthometric Height: **1032.06**sft Ellipsoid Height: **926.85**sft **Geoid03**

Latitude: **40°37'46.22568"N** Longitude: **92°55'06.25812"W**

Mapping Angle: **0°22'59"** Combination Scale Factor: **0.99995353**

**Monument Type:** The station mark is a Coast & Geodetic Survey bench mark disk stamped "1031.865 X 7 1930" and set in the top of concrete post located 2ft E of a pink harn sign.

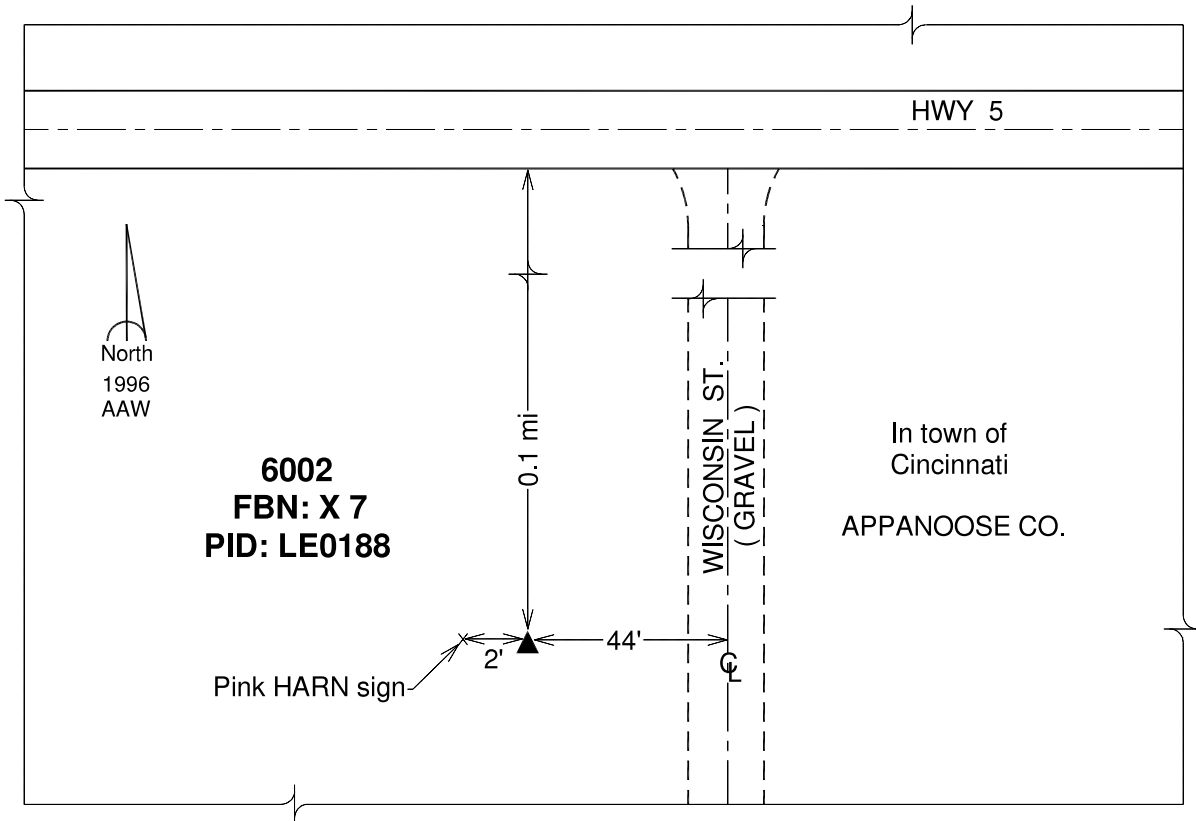

*This document was prepared by DCI and GBC for use by Wayne County, Iowa.*