

Wayne County, Iowa
Iowa South Zone (1402)
Horiz. Datum: NAD83(NSRS2007)
Vert. Datum: NAVD 1988
US Survey Feet
2007

Point Name: 62

Designation: S 1/4 Corner of Sec 22 T67N R21W, Howard Township

Northing: 211724.56sft Easting: 1706963.53sft

Orthometric Height: 1097.42sft Ellipsoid Height: 993.58sft Geoid03

Latitude: 40°34'51.16091"N

Longitude: 93°15'37.54745"W

Mapping Angle: 0°09'28"

Combination Scale Factor: 0.99995910

Monument Type: Lead plug set in concrete pavement.

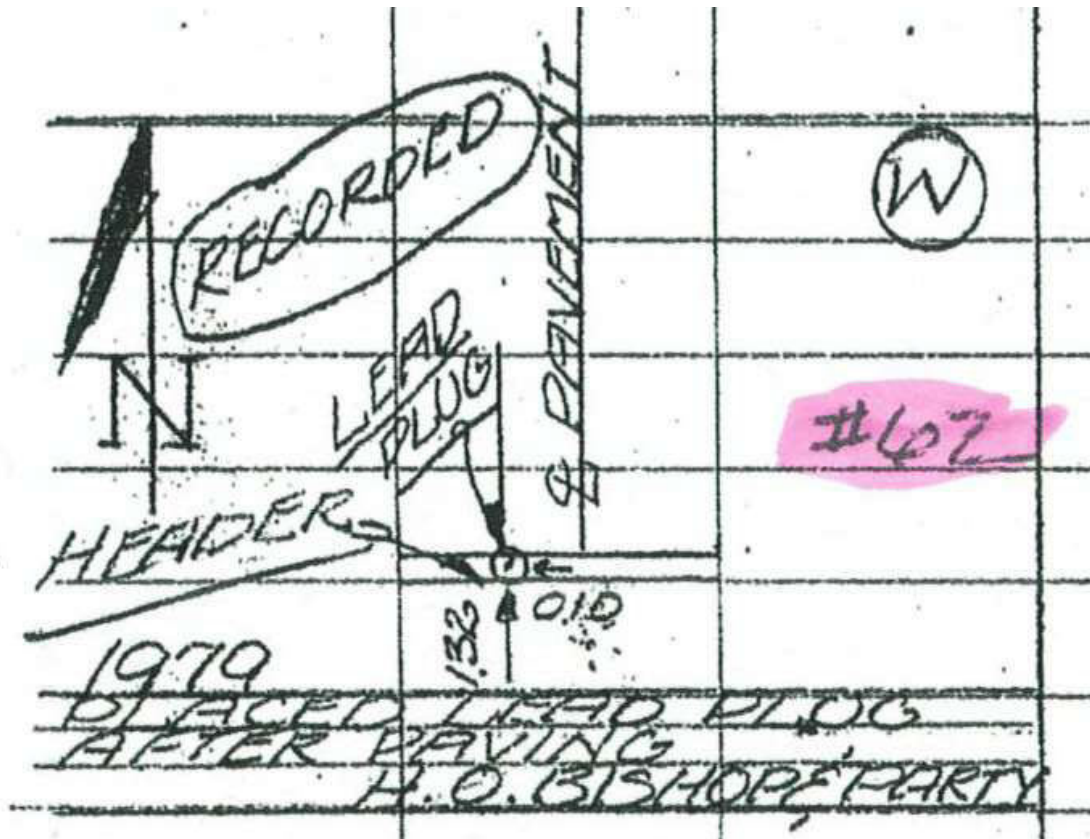

This document was prepared by DCI and GBC for use by Wayne County, Iowa.