

**Wayne County, Iowa**  
Iowa South Zone (1402)  
Horiz. Datum: NAD83(NSRS2007)  
Vert. Datum: NAVD 1988  
US Survey Feet  
**2007**

Point Name: **63**

**Designation:** NE Corner of Sec 4 T68N R21W, Jackson Township

Northing: **264066.44**sft Easting: **1704343.76**sft

Orthometric Height: **1013.49**sft Ellipsoid Height: **909.82**sft **Geoid03**

Latitude: **40°43'28.43392"N** Longitude: **93°16'09.70098"W**

Mapping Angle: **0°09'07"** Combination Scale Factor: **0.99993929**

**Monument Type:** Lead plug set in concrete pavement.

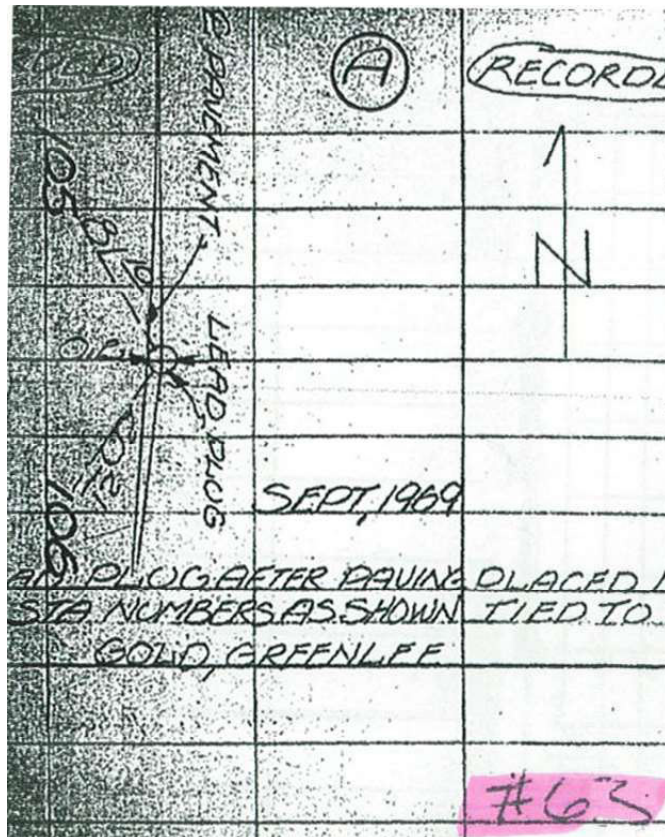

*This document was prepared by DCI and GBC for use by Wayne County, Iowa.*