

Wayne County, Iowa
 Iowa South Zone (1402)
 Horiz. Datum: NAD83(NSRS2007)
 Vert. Datum: NAVD 1988
 US Survey Feet
2007

Point Name: **7420**

Designation: TBM near NGS 2nd order control station "N 81" PID:LE0420

Northing: **188288.08**sft Easting: **1631557.50**sft

Orthometric Height: **1079.57**sft Ellipsoid Height: **976.03**sft **Geoid03**

Latitude: **40°31'00.46810"N** Longitude: **93°31'54.70449"W**

Mapping Angle: **-0°01'16"** Combination Scale Factor: **0.99997255**

Monument Type: The temporary bench mark is a 1/2" rebar driven vertically into the ground. The top of the rebar is flush with the ground surface.

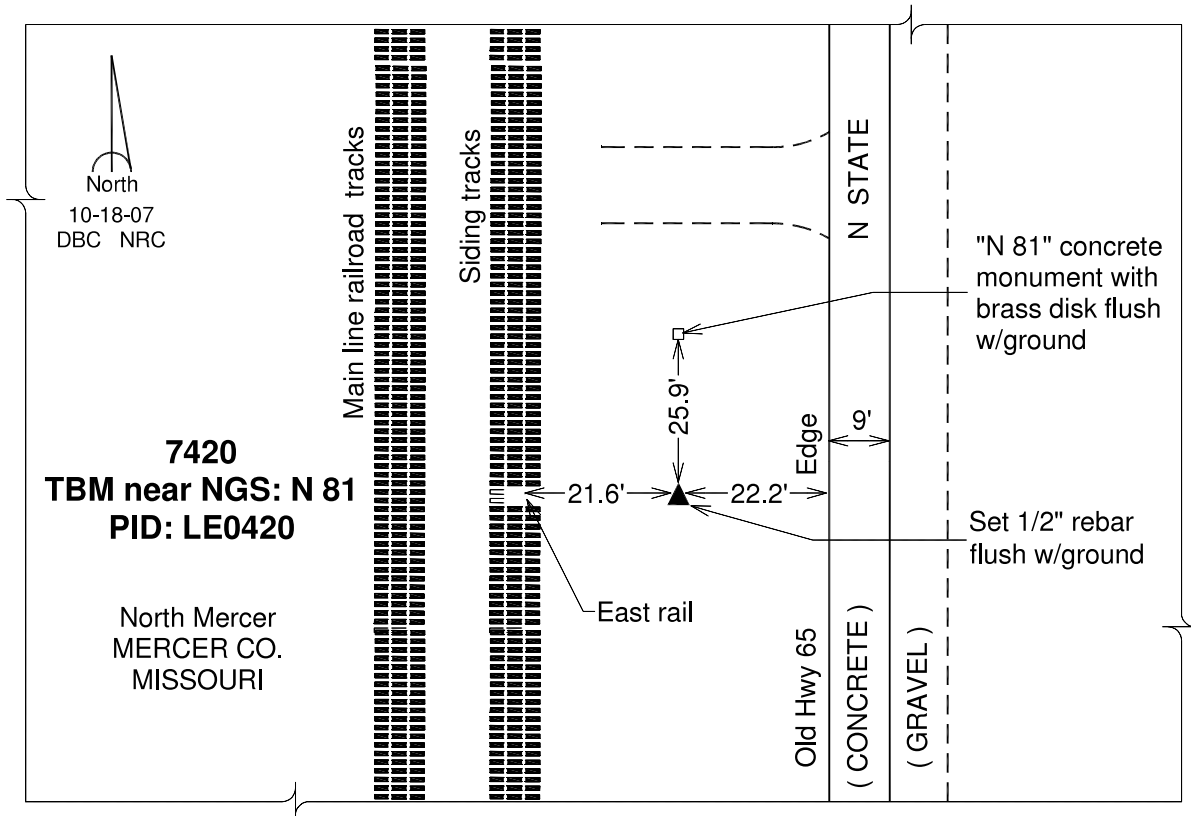

This document was prepared by DCI and GBC for use by Wayne County, Iowa.