

Wayne County, Iowa
Iowa South Zone (1402)
Horiz. Datum: NAD83(NSRS2007)
Vert. Datum: NAVD 1988
US Survey Feet
2007

Point Name: **8**

Designation: CBN horizontal and 3rd order vertical control station "FAIRALL" PID:LE0532

Northing: **279840.17**sft Easting: **1643959.19**sft

Orthometric Height: **1109.94**sft Ellipsoid Height: **1006.56**sft **Geoid03**

Latitude: **40°46'05.13319"N** Longitude: **93°29'13.95876"W**

Mapping Angle: **0°00'30"** Combination Scale Factor: **0.99992870**

Monument Type: The station mark is a CGS triangulation station disk stamped "Fairall 1928" set in the top of a square concrete monument that projects 12 inches.

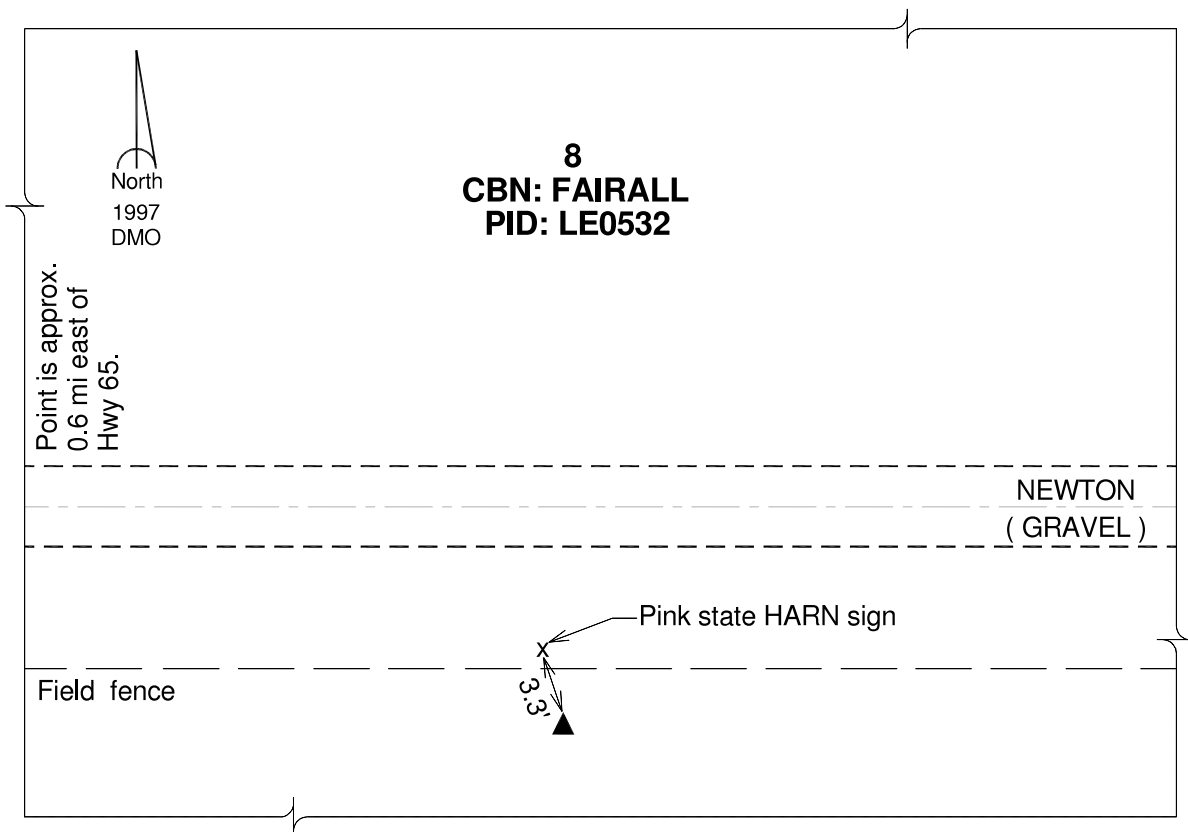

This document was prepared by DCI and GBC for use by Wayne County, Iowa.