

GPS SURVEY MARK DESCRIPTION

GIS MAPPING BY:
THE SIDWELL COMPANY
WEST CHICAGO, ILLINOIS

THE OFFICE OF THE
COUNTY ENGINEER
WEBSTER COUNTY, IOWA

DESIGNATION 902931 3 GPS No. 6009 COUNTY WEBSTER STATE IOWA

LOCATED IN SECTION 31 TWP 90 N RGE 29 W USGS QUAD MAP CLARE

TO REACH FROM INTERSECTION OF 160TH STREET AND HAYES AVENUE: GO WEST 1.0 MILE TO FIELD

ENTRANCE NORTH AND MARK.

MARK ON PRIVATE PROPERTY WITH PERMISSION OF OWNER. OWNER IN COMPLEX WEST OF MARK.

TYPE OF MARK BERNTSEN TOP SECURITY ROD MONUMENT WITH 3-1/4" ALUM. CAP SET WITHIN ACCESS COVER

RECOVERED SET BY DENI ASSOCIATES, INC., FT. MYERS, FL DATE AUGUST 1996

HORIZONTAL CONTROL ORIGINATED ON ORDER "B" CONTROL BASED ON THE IOWA HIGH ACCURACY REFERENCE NETWORK, NORTH AMERICAN DATUM OF 1983/1997 ADJUSTMENT (NAD83/97).

IOWA COORDINATE SYSTEM, NORTH ZONE GRID SCALE FACTOR: _____

COORDINATES (US FEET) COORDINATES (METERS)

NORTHING (Y) _____ NORTHING (Y) _____

EASTING (X) _____ EASTING (X) _____

VERTICAL CONTROL ORIGINATED ON 1ST ORDER CONTROL ESTABLISHED BY NATIONAL GEODETIC SURVEY ON NORTH AMERICAN VERTICAL DATUM OF 1988 (NAVD88).

ELEVATION (US FEET) _____ ELEVATION (METERS) _____

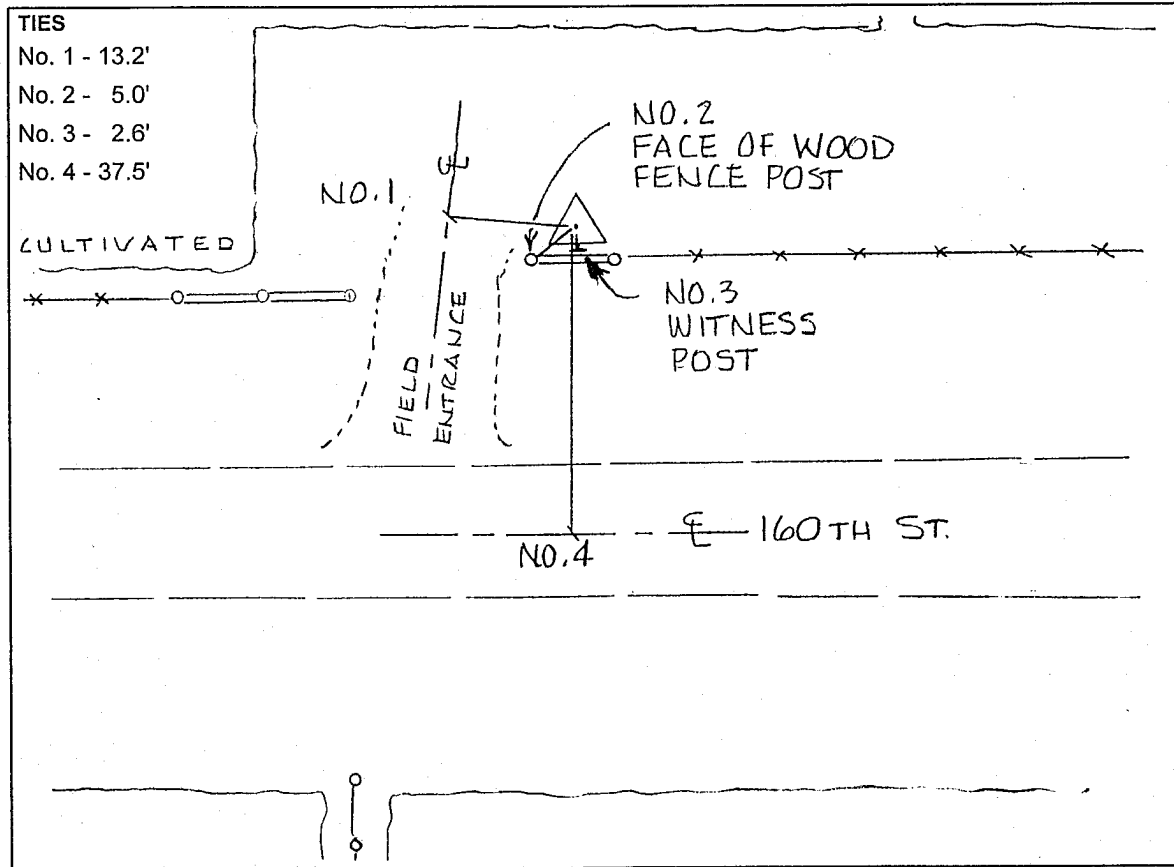

- TIES
- No. 1 - 13.2'
 - No. 2 - 5.0'
 - No. 3 - 2.6'
 - No. 4 - 37.5'

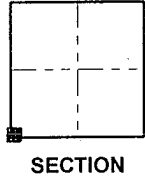

SKETCH
BY DSW
DENI 9605023