

# GPS SURVEY MARK DESCRIPTION

GIS MAPPING BY:  
THE SIDWELL COMPANY  
WEST CHICAGO, ILLINOIS

THE OFFICE OF THE  
COUNTY ENGINEER  
WEBSTER COUNTY, IOWA

DESIGNATION 883015 3 GPS No. 6056 COUNTY WEBSTER STATE IOWA  
 LOCATED IN SECTION 15 TWP 88 N RGE 30 W USGS QUAD MAP MOORLAND  
 TO REACH FROM IN THE NORTHEAST QUADRANT OF THE INTERSECTION OF 250TH STREET AND  
DAKOTA AVENUE, SOUTHWEST OF MOORLAND.

TYPE OF MARK BERNTSEN TOP SECURITY ROD MONUMENT WITH 3-1/4" ALUM. CAP SET WITHIN ACCESS COVER

RECOVERED  SET BY DENI ASSOCIATES, INC., FT. MYERS, FL DATE AUGUST 1996

HORIZONTAL CONTROL ORIGINATED ON ORDER "B" CONTROL BASED ON THE IOWA HIGH ACCURACY REFERENCE NETWORK, NORTH AMERICAN DATUM OF 1983/1997 ADJUSTMENT (NAD83/97).

IOWA COORDINATE SYSTEM, NORTH ZONE GRID

SCALE FACTOR: \_\_\_\_\_

COORDINATES (US FEET)

COORDINATES (METERS)

NORTHING (Y) \_\_\_\_\_

NORTHING (Y) \_\_\_\_\_

EASTING (X) \_\_\_\_\_

EASTING (X) \_\_\_\_\_

VERTICAL CONTROL ORIGINATED ON 1ST ORDER CONTROL ESTABLISHED BY NATIONAL GEODETIC SURVEY ON NORTH AMERICAN VERTICAL DATUM OF 1988 (NAVD88).

ELEVATION (US FEET) \_\_\_\_\_

ELEVATION (METERS) \_\_\_\_\_

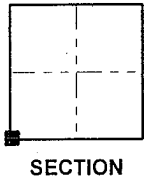
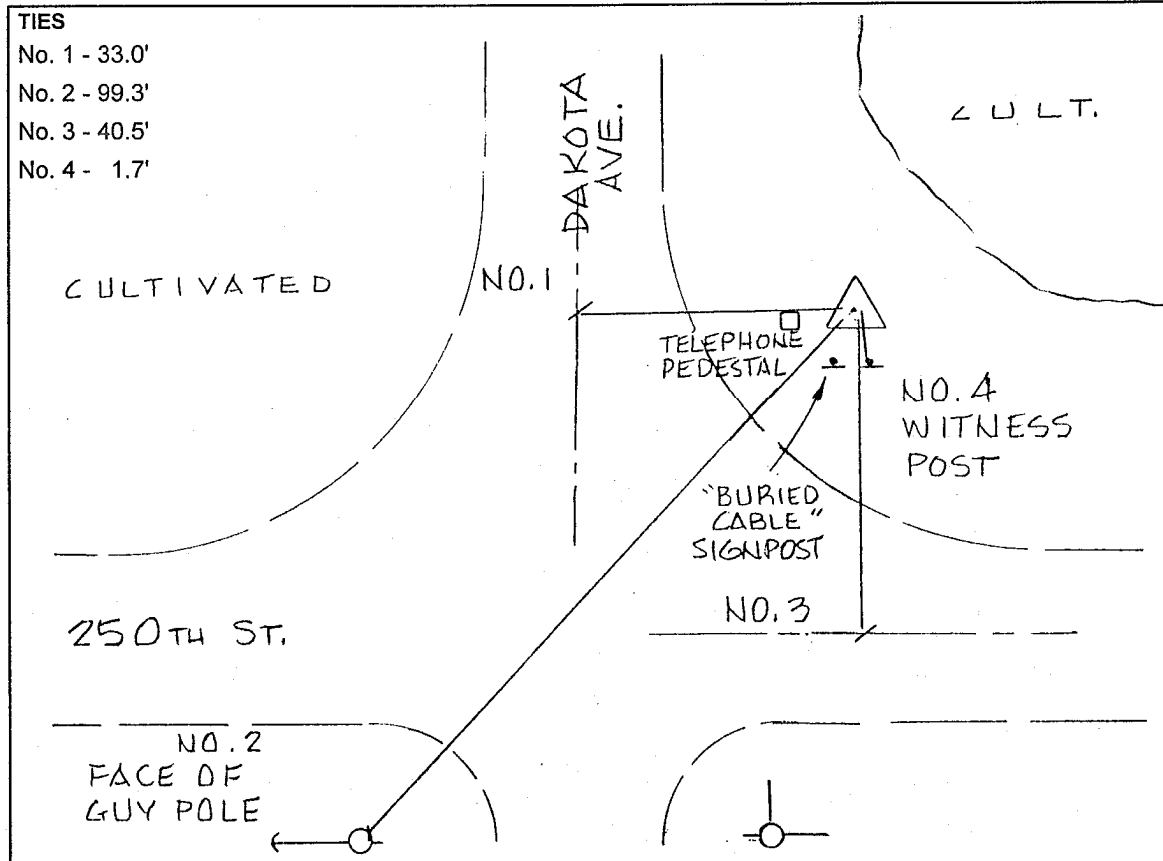

SKETCH  
 BY DSW  
 DENI 9605023