

# GPS SURVEY MARK DESCRIPTION

GIS MAPPING BY:  
THE SIDWELL COMPANY  
WEST CHICAGO, ILLINOIS

THE OFFICE OF THE  
COUNTY ENGINEER  
WEBSTER COUNTY, IOWA

DESIGNATION 893018 3 GPS No. 6062 COUNTY WEBSTER STATE IOWA  
 LOCATED IN SECTION 18 TWP 89 N RGE 30 W USGS QUAD MAP GILMORE CITY SW  
 TO REACH FROM IN THE NORTHEAST QUADRANT OF THE INTERSECTION OF STATE HIGHWAY 7 (190TH STREET)  
AND ADAMS AVENUE, AT THE WEBSTER - CALHOUN COUNTY LINE.

TYPE OF MARK BERNTSEN TOP SECURITY ROD MONUMENT WITH 3-1/4" ALUM. CAP SET WITHIN ACCESS COVER  
 RECOVERED  SET BY DENI ASSOCIATES, INC., FT. MYERS, FL DATE AUGUST 1996

HORIZONTAL CONTROL ORIGINATED ON ORDER "B" CONTROL BASED ON THE IOWA HIGH ACCURACY REFERENCE NETWORK, NORTH AMERICAN DATUM OF 1983/1997 ADJUSTMENT (NAD83/97).

IOWA COORDINATE SYSTEM, NORTH ZONE GRID SCALE FACTOR: \_\_\_\_\_  
 COORDINATES (US FEET) COORDINATES (METERS)  
 NORTHING (Y) \_\_\_\_\_ NORTHING (Y) \_\_\_\_\_  
 EASTING (X) \_\_\_\_\_ EASTING (X) \_\_\_\_\_

VERTICAL CONTROL ORIGINATED ON 1ST ORDER CONTROL ESTABLISHED BY NATIONAL GEODETIC SURVEY ON NORTH AMERICAN VERTICAL DATUM OF 1988 (NAVD88).

ELEVATION (US FEET) \_\_\_\_\_ ELEVATION (METERS) \_\_\_\_\_

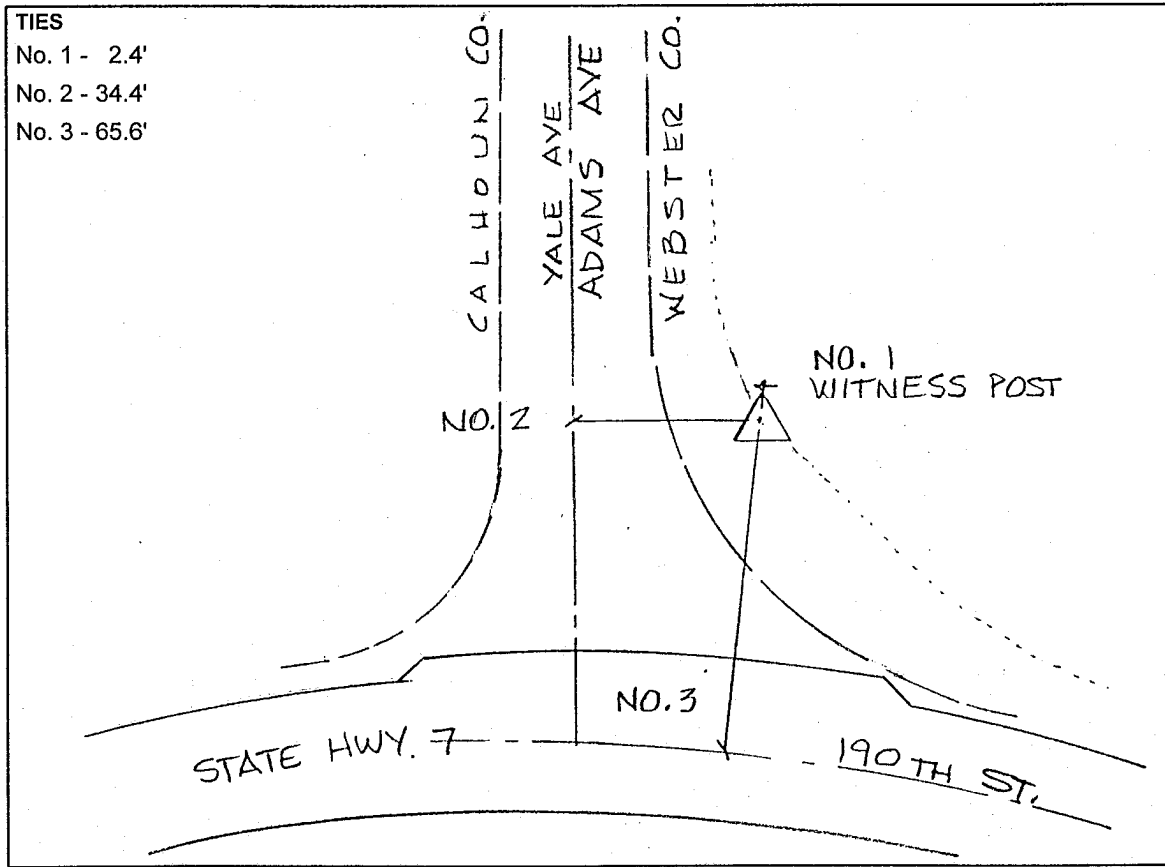

- TIES  
 No. 1 - 2.4'  
 No. 2 - 34.4'  
 No. 3 - 65.6'

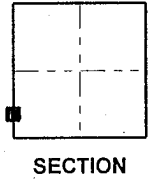

SKETCH  
 BY DSW  
 DENI 9605023