

# GPS SURVEY MARK DESCRIPTION

GIS MAPPING BY:  
THE SIDWELL COMPANY  
WEST CHICAGO, ILLINOIS

THE OFFICE OF THE  
COUNTY ENGINEER  
WEBSTER COUNTY, IOWA

DESIGNATION 862806 4 GPS No. 6079 COUNTY WEBSTER STATE IOWA

LOCATED IN SECTION 6 TWP 86 N RGE 28 W USGS QUAD MAP HARCOURT

TO REACH FROM THE INTERSECTION OF U.S. 169 (LAINSON AVENUE) AND 340TH STREET, NORTH OF HARCOURT:  
GO EAST 1.25 MILES TO MARK; 800 FEET MORE OR LESS WEST OF THE BRIDGE OVER EAST BRANCH BUTTRICK  
CREEK.

TYPE OF MARK BERNTSEN TOP SECURITY ROD MONUMENT WITH 3-1/4" ALUM. CAP SET WITHIN ACCESS COVER

RECOVERED  SET BY DENI ASSOCIATES, INC., FT. MYERS, FL DATE AUGUST 1996

HORIZONTAL CONTROL ORIGINATED ON ORDER "B" CONTROL BASED ON THE IOWA HIGH ACCURACY REFERENCE NETWORK, NORTH AMERICAN DATUM OF 1983/1997 ADJUSTMENT (NAD83/97).

IOWA COORDINATE SYSTEM, NORTH ZONE GRID

SCALE FACTOR: \_\_\_\_\_

COORDINATES (US FEET)

COORDINATES (METERS)

NORTHING (Y) \_\_\_\_\_

NORTHING (Y) \_\_\_\_\_

EASTING (X) \_\_\_\_\_

EASTING (X) \_\_\_\_\_

VERTICAL CONTROL ORIGINATED ON 1ST ORDER CONTROL ESTABLISHED BY NATIONAL GEODETIC SURVEY ON NORTH AMERICAN VERTICAL DATUM OF 1988 (NAVD88).

ELEVATION (US FEET) \_\_\_\_\_

ELEVATION (METERS) \_\_\_\_\_

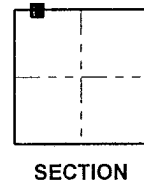
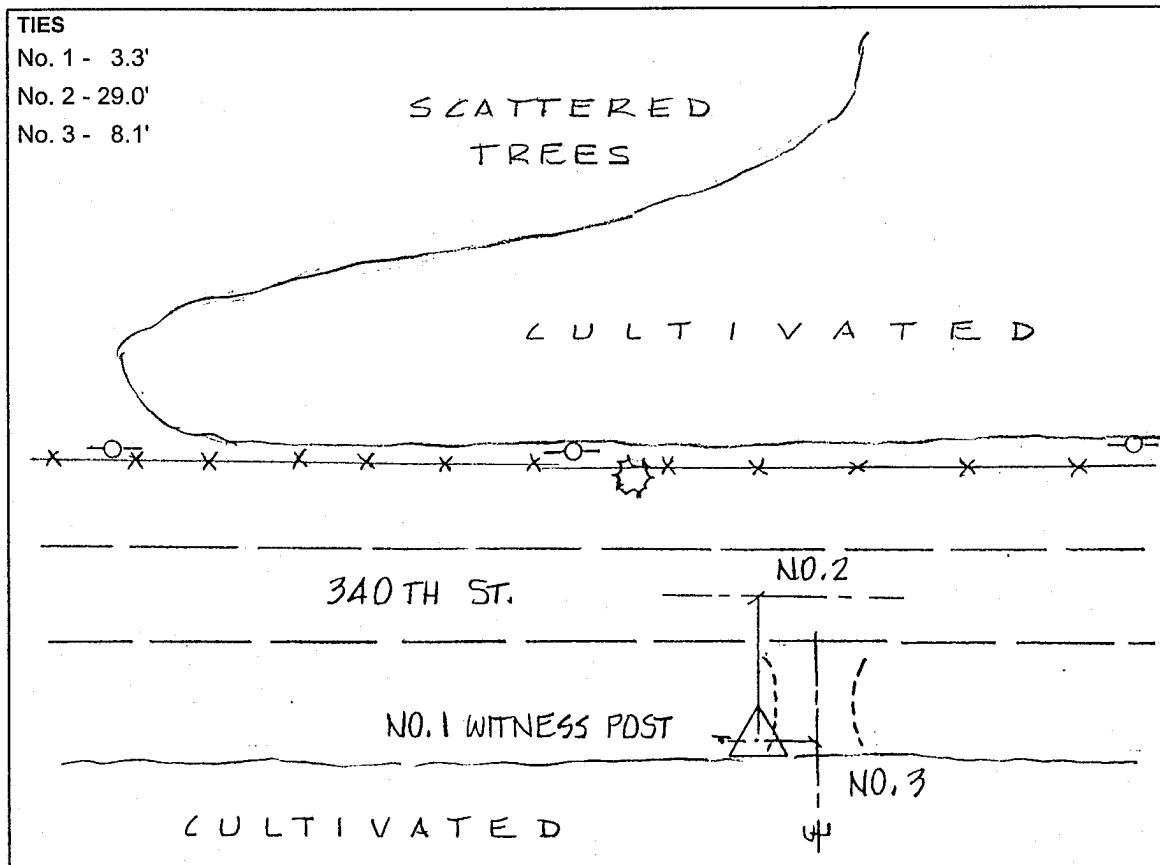

SKETCH  
BY DSW

DENI 9605023