

in

THIRD-ORDER LEVELS
NATIONAL GEODETIC VERTICAL DATUM OF 1929

UNITED STATES
DEPARTMENT OF THE INTERIOR
GEOLOGICAL SURVEY

42-094-42
MANSON QUADRANGLE
203 - IOWA
N4230-W9430/15
DIAGRAM NK 15-4
FT. DODGE

Pocahontas and Calhoun Counties

Final Adjustment of 1974

Edition of: 3-10-75

PR:ADP/cb

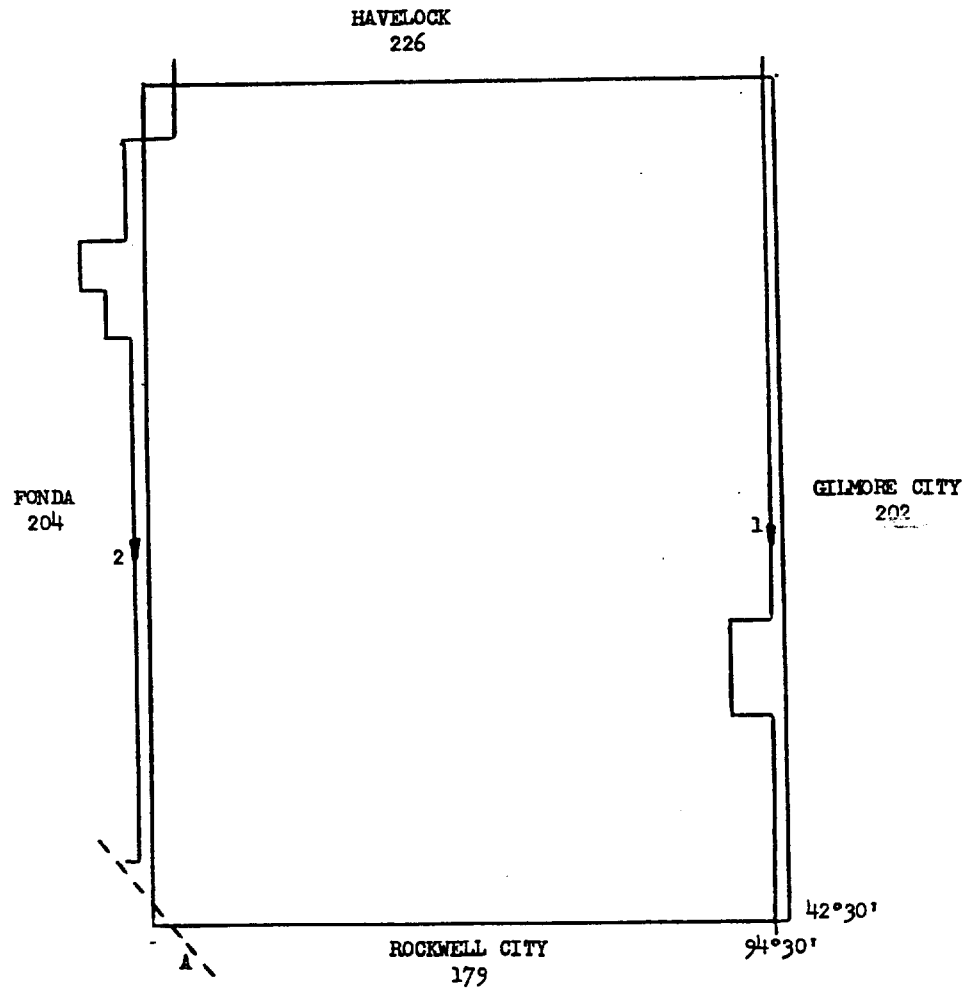

N.G.S. (USC&GS) VERTICAL CONTROL DATA

A. Quadrangle No. 420944

203A

LINE 1 (Cont'd)

MANSON QUAD. - 203

FEET

3	40	14.9	UE 14 MK B, 1.9 mi S. along road from tablet, 225 ft S. along road from sec. line fence, 21 ft W. of centerline of road on W. end of 30-in. concrete culvert, a chiseled square	1226.69
42	15.8		Reference mark, 64.4 ft E. from tablet, 27 ft E. of centerline of road at dirt T-rd.; atop a copper clad rod; painted white	1233.21
44	15.8		Clare, 8 mi W. and 1 mi N. from near the cor. of secs. 15, 16, 21 and 22, T. 90 N., R. 31 W., 33 ft W. and 24 ft S. from centerline of road at dirt T-rd. W., 1 ft N. of witness sign, 2 ft E. of a steel angle iron fence post, a standard rod supported tablet, stamped "15 MK 1974"	1234.383
46	16.8		UE 15 MK A, 1 mi S. along road from tablet, 74 ft N. and 19 ft W. and 3.2 ft lower than centerline of crossroads on the W. end of a concrete culvert, a chiseled square	1225.80
48	17.9		UE 15 MK B, 1 mi S. and 1 mi W. along road from tablet near the cor. of secs. 20, 21, 28 and 29, T. 90 N., R. 31 W., 34 ft N., 29.5 ft E. and 1.7 ft lower than centerline of crossroads on the W. end of a concrete culvert, a chiseled square	1202.77
51	18.5		Reference mark, 124 ft N. from tablet, 15 ft E. and 66 ft N. of centerline of bridge, on the N. end of the E. br. curb, a chiseled square	1208.39
52	18.5		Clare, 9 mi W. from and .63 mi S. along roads from, in the SE $\frac{1}{4}$ of sec. 29, T. 90 N., R. 31 W., 58 ft S., 15 ft W. from the centerline of the bridge in the S. end of the W. br. curb, a standard tablet embedded in concrete stamped "16 MK 1974"	1207.566
55	19.9		UE 16 MK A, 1.4 mi S. along road from tablet, near the cor. of secs. 4, 5, 32 and 33, Ts. 89 and 90 N., R. 31 W., 59 ft E., 36 ft N. and 3.4 ft lower than centerline of crossroads on the E. end of a concrete culvert, a chiseled square	1242.17
57	20.9		UE 16 MK B, 1.4 mi S. and 1 mi E. along roads from tablet in the NE. cor. of sec. 4, T. 89 N., R. 31 W., 53 ft W., 21 ft S. and 2.2 ft lower than centerline of T-rd. S., on the S. end of a concrete culvert; a chiseled square	1211.54
59	21.8		Reference mark, 67 ft N. of tablet, 35 ft W. and 32 ft S. of centerline of crossroads atop a copperweld rod, painted white, projecting about 6-in.	1231.18
60	21.8		Manson, 2 mi E. and 1 mi N. from, near the cor. of secs. 3, 4, 9 and 10, T. 89 N., R. 31 W., 34 ft S., and 32 ft E. from centerline of crossroads, 1 ft W. of utility pole, 2 ft N. of fence corner post, a standard rod supported tablet stamped "17 MK 1974"	1229.950
62	22.8		UE 17 MK A, 1 mi S. along road from tablet, in the SE. cor. of sec. 9, T. 89 N., R. 31 W., 45 ft N., 40 ft W. and 1.4 ft lower than centerline of crossroads, 1 ft SE. of fence atop a copperweld rod; painted white	1246.56
64	23.8		UE 17 MK B, centerline of crossroads painted x, 2 mi S. along road from tablet at the centerline of an E.-W. concrete road and a gravel N.-S. road, a painted X	1231.24
<u>GOWRIE QUAD. - 178</u>				
66	24.8		Knierim, 3 mi N., 2.5 mi W. of; T. 89 N., R. 31 W., near cor. secs. 21, 22, 27 and 28; 43 ft S., 41 ft E. of and 2.1 ft lower than center of road at T-rd. E., at offset crossroads; 5 ft E. of and 1 ft N. of a fence corner; in top of concrete post; standard tablet stamped "2 WMC 1964 1201" painted "BM 1201.4"	1201.462