

**WINNEBAGO COUNTY, IOWA
GPS CONTROL MONUMENT
IOWA NORTH ZONE (1401)
HORIZONTAL DATUM - NAD 83 (1996)
VERTICAL DATUM - NAVD 1988**

GPS POINT NUMBER **G2**

	US SURVEY FEET	METRIC
Northing:	3920323.564	1194917.012
Easting:	4827453.206	1471410.680
Elevation:	1256.764	383.062
Ellipsoid Height:	1160.905	353.844
Geoid 99 Height:	-95.859	-29.218

Latitude:	43°15'15.13500"N
Longitude:	93°51'07.45065"W
Scale Factor:	0.9999977467
Convergence:	-0°14'19"
Combined Factor:	0.99994236

Description:

Found NGS Style Aluminum Monument With Access Cover

Location:

On the east side of Grant Avenue (Hancock Co.) - 500'± south of NW Corner Section 6-T97N-R25W.

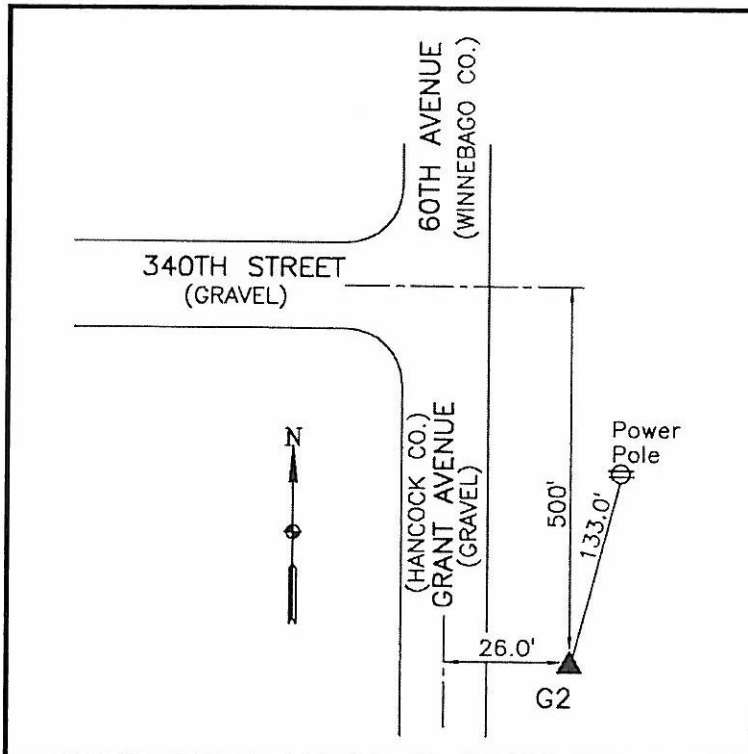

WHKS & CO.