

**WINNEBAGO COUNTY, IOWA  
GPS CONTROL MONUMENT  
IOWA NORTH ZONE (1401)  
HORIZONTAL DATUM - NAD 83 (1996)  
VERTICAL DATUM - NAVD 1988**

GPS POINT NUMBER **G5**

	US SURVEY FEET	METRIC
Northing:	3920480.286	1194964.781
Easting:	4921845.032	1500181.366
Elevation:	1262.878	384.926
Ellipsoid Height:	1167.192	355.761
Geoid 99 Height:	-95.685	-29.165

Latitude:	43°15'18.61189"N
Longitude:	93°29'51.95939"W
Scale Factor:	0.9999979197
Convergence:	0°00'05"
Combined Factor:	0.99994220

Description:

Found NGS Style Aluminum Monument With Access Cover

Location:

SW Corner of 340th Street and Apple Avenue - near SE Corner Section 36-T98N-R23W.

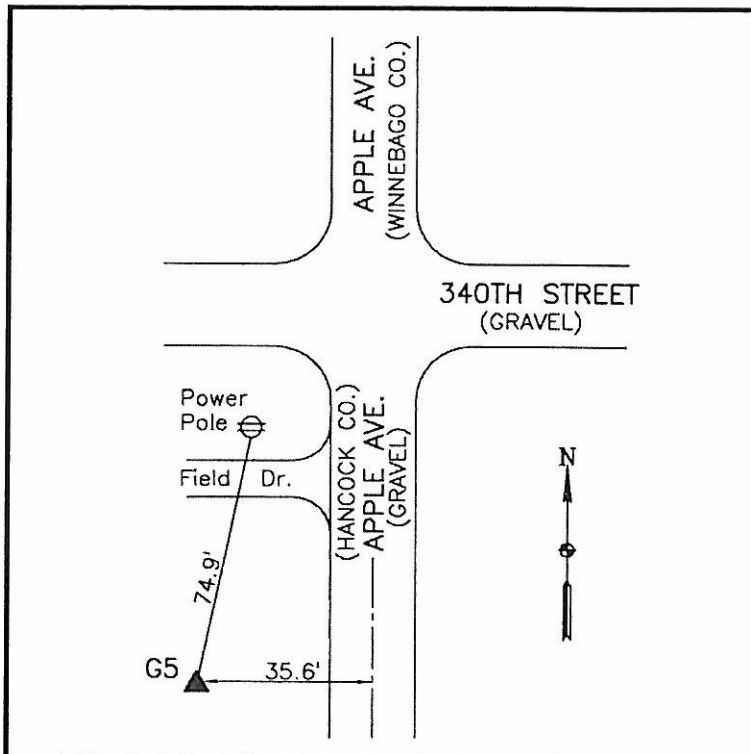

**WHKS & CO.**