

**WINNEBAGO COUNTY, IOWA
GPS CONTROL MONUMENT
IOWA NORTH ZONE (1401)
HORIZONTAL DATUM - NAD 83 (1996)
VERTICAL DATUM - NAVD 1988**

GPS POINT NUMBER **G131**

	US SURVEY FEET	METRIC
Northing:	3965670.690	1208738.844
Easting:	4920743.118	1499845.502
Elevation:	1244.980	379.471
Ellipsoid Height:	1148.608	350.097
Geoid 99 Height:	-96.372	-29.374

Latitude:	43°22'44.93613"N
Longitude:	93°30'06.86322"W
Scale Factor:	1.0000224929
Convergence:	-0°00'05"
Combined Factor:	0.99996769

Description:

Placed 5/8" X 6' - 0" Long Aluminum Rod with Cap Stamped G131 and NGS Style Access Cover 2 " Deep.

Location:

On south side 425th Street (County Road A34) - at end of curve - 0.2± mile east of entrance to Rice Lake Golf Course (235th Avenue) east of center Section 24-T99N-R23W.

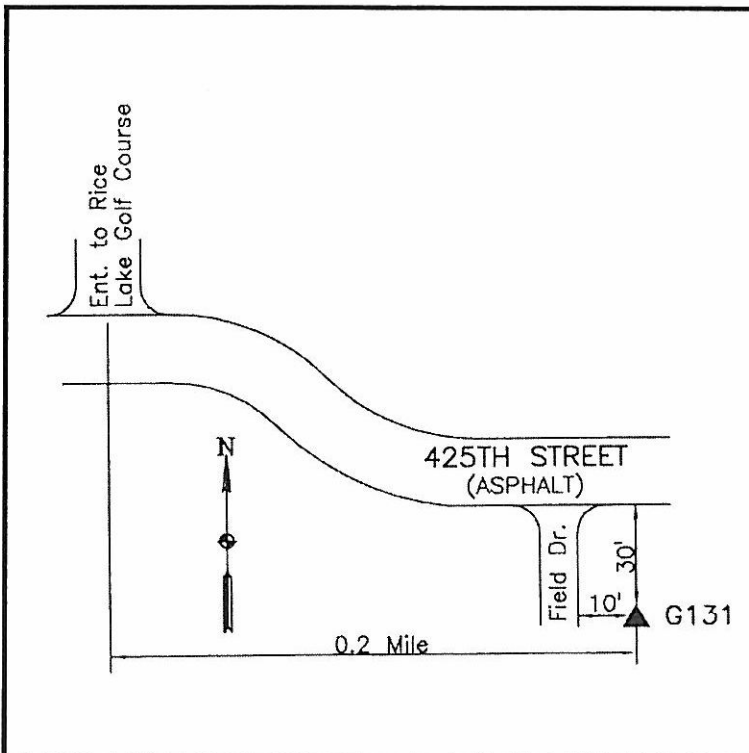

WHKS & CO.