

**WINNEBAGO COUNTY, IOWA  
GPS CONTROL MONUMENT  
IOWA NORTH ZONE (1401)  
HORIZONTAL DATUM - NAD 83 (1996)  
VERTICAL DATUM - NAVD 1988**

GPS POINT NUMBER **G137**

	US SURVEY FEET	METRIC
Northing:	3984284.165	1214412.242
Easting:	4844161.384	1476503.343
Elevation:	1234.321	376.222
Ellipsoid Height:	1138.576	347.039
Geoid 99 Height:	-95.745	-29.183

Latitude:	43°25'47.45983"N
Longitude:	93°47'24.64616"W
Scale Factor:	1.0000339018
Convergence:	-0°11'48"
Combined Factor:	0.99997958

**Description:**

Placed 5/8" X 6' - 0" Long Aluminum Rod with Cap Stamped G137 and NGS Style Access Cover 3 " Deep.

**Location:**

On north side 460th Street - 0.2± mile east of 90th Avenue - 30'± west of field entrance - near NW Corner Section 3-T99N-R25W.

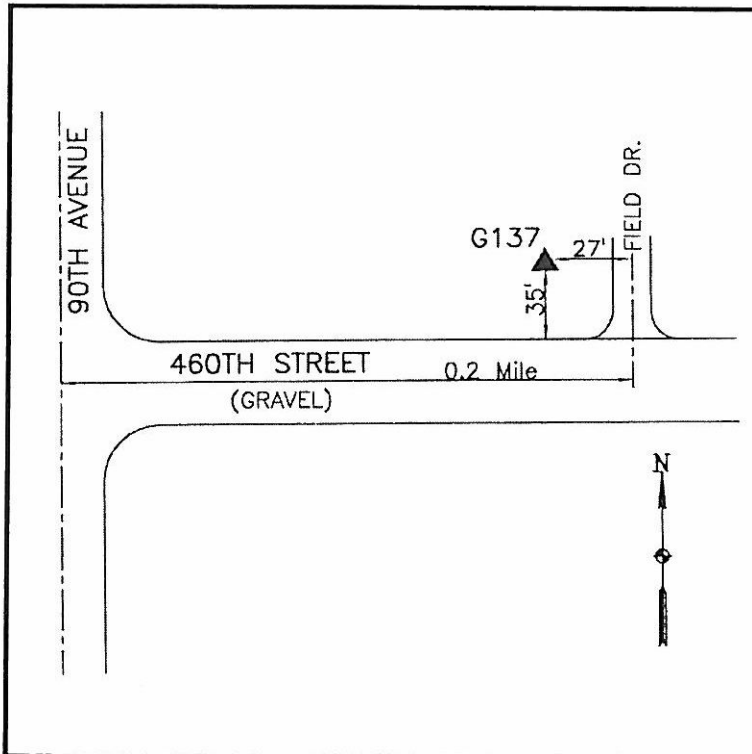

**WHKS & CO.**