

2014 Winneshiek County, Iowa
Horizontal Datum: **NAD 83(2011)** - Vertical Datum: **NAVD 1988**
Iowa North Zone (1401)
Iowa Regional Coordinate System Zone 2 Mason City
US Survey Feet

Point Name: **10108**

NAD 83(2011) Latitude: **N43°30'01.57609"** Longitude: **W91°40'14.35260"**

NAVD 88 Ortho Height: **1147.420sft** Ellip. Ht: **1048.014sft** **Geoid12A**

Mapping Angle: **1°14'23"** Combination Scale Factor: **1.0000010987**

Iowa North Zone (1401) Northing: **4015134.563sft** Easting: **5406637.525sft**

IaRCS Zone 2 Northing: **9923510.415sft** Easting: **12786404.101sft**

Location: Near the NW Cor of Sec 10 T100N R7W.

Designation: WINNESHIEK COUNTY GPS CONTROL PT 2003-108

Monument Type: 5/8" dia driven aluminum rod with a 2-1/2" dia aluminum cap and permanent magnet encased in a 5" dia PVC pipe with an aluminum access cover.

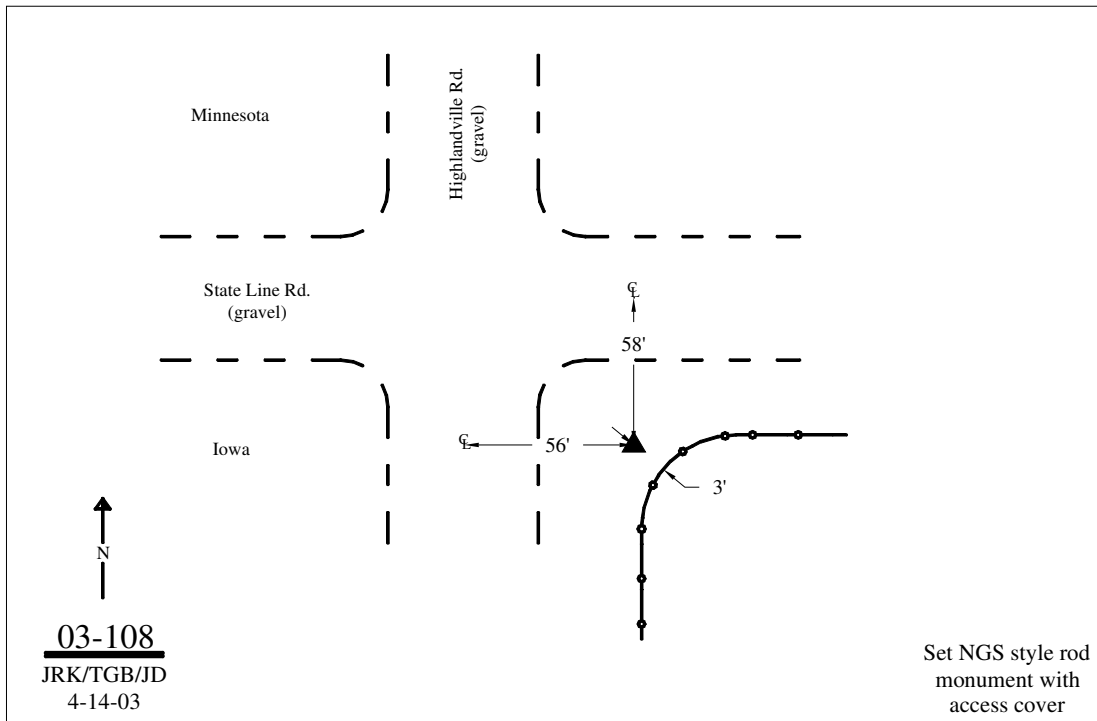

This document was prepared by DCI on February 7, 2014 for use by Winneshiek County, Iowa