

2014 Winneshiek County, Iowa
 Horizontal Datum: **NAD 83(2011)** - Vertical Datum: **NAVD 1988**
 Iowa North Zone (1401)
 Iowa Regional Coordinate System Zone 2 Mason City
 US Survey Feet

Point Name: **10109**

NAD 83(2011) Latitude: **N43°28'18.48369"** Longitude: **W92°01'41.88993"**

NAVD 88 Ortho Height: **1185.830sft** Ellip. Ht: **1086.480sft** **Geoid12A**

Mapping Angle: **0°59'51"** Combination Scale Factor: **0.9999921009**

Iowa North Zone (1401) Northing: **4002844.553sft** Easting: **5311933.542sft**

IaRCS Zone 2 Northing: **9912051.428sft** Easting: **12691594.918sft**

Location: Near the NW Cor of Sec 22 T100N R10W.

Designation: WINNESHIEK COUNTY GPS CONTROL PT 2003-109

Monument Type: 5/8" dia driven aluminum rod with a 3-1/2" dia aluminum cap and permanent magnet encased in a 5" dia PVC pipe with an aluminum access cover.

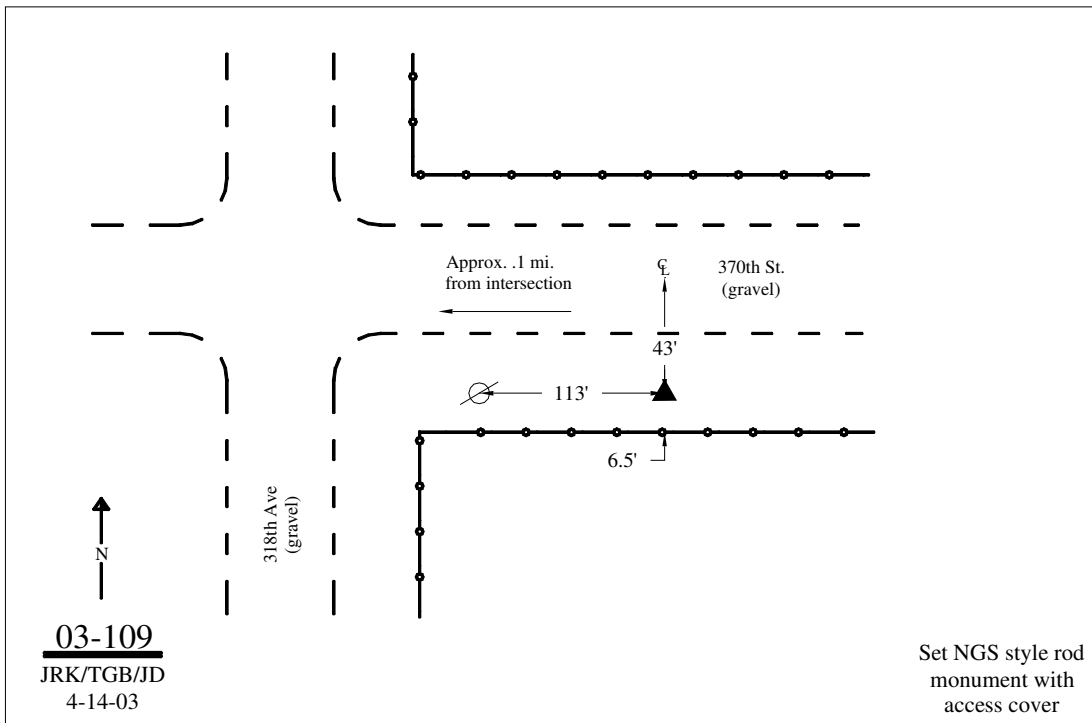

This document was prepared by DCI on February 7, 2014 for use by Winneshiek County, Iowa