

2014 Winneshiek County, Iowa
Horizontal Datum: **NAD 83(2011)** - Vertical Datum: **NAVD 1988**
Iowa North Zone (1401)
Iowa Regional Coordinate System Zone 2 Mason City
US Survey Feet

Point Name: **10115**

NAD 83(2011) Latitude: **N43°28'17.83737"** Longitude: **W91°40'12.57286"**

NAVD 88 Ortho Height: **1132.610**sft Ellip. Ht: **1033.237**sft **Geoid12A**

Mapping Angle: **1°14'25"** Combination Scale Factor: **0.9999945971**

Iowa North Zone (1401) Northing: **4004635.593**sft Easting: **5406996.025**sft

IaRCS Zone 2 Northing: **9913008.593**sft Easting: **12786670.710**sft

Location: Near the SW Cor of Sec 15 T100N R7W.

Designation: WINNESHIEK COUNTY GPS CONTROL PT 2003-115

Monument Type: 5/8" dia driven aluminum rod with a 2-1/2" dia aluminum cap and permanent magnet encased in a 5" dia PVC pipe with an aluminum access cover.

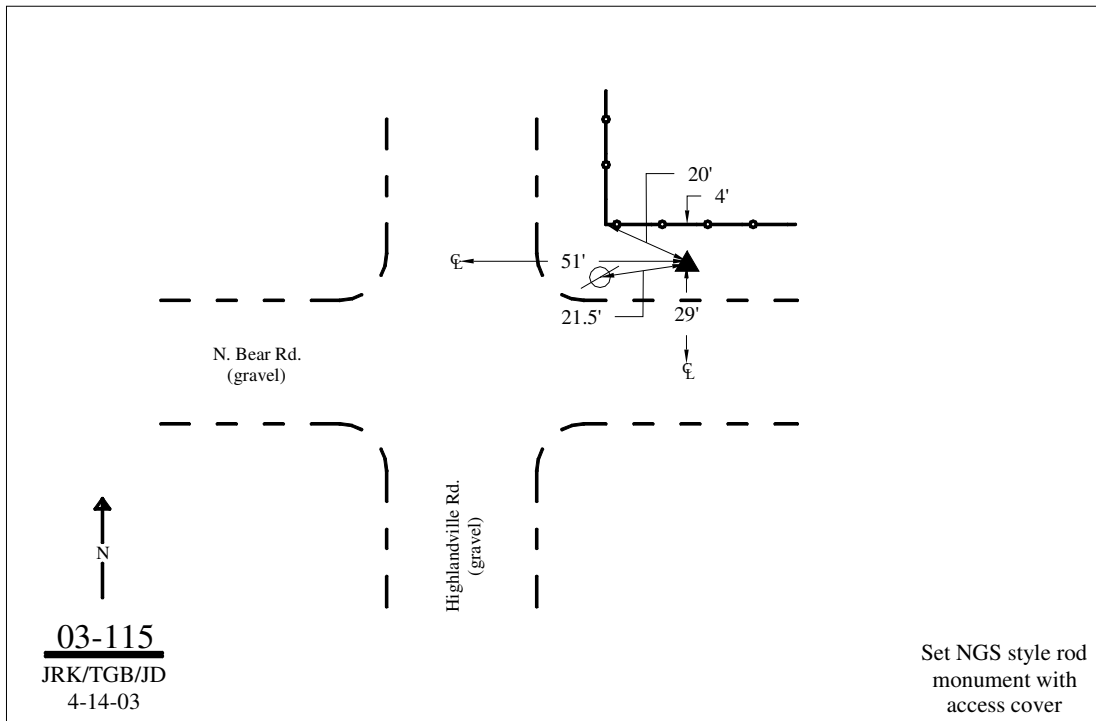

This document was prepared by DCI on February 7, 2014 for use by Winneshiek County, Iowa