

2014 Winneshiek County, Iowa
Horizontal Datum: **NAD 83(2011)** - Vertical Datum: **NAVD 1988**
Iowa North Zone (1401)
Iowa Regional Coordinate System Zone 2 Mason City
US Survey Feet

Point Name: **10124**

NAD 83(2011) Latitude: **N43°23'06.65936"** Longitude: **W92°01'41.56290"**

NAVD 88 Ortho Height: **1190.490sft** Ellip. Ht: **1091.202sft** **Geoid12A**

Mapping Angle: **0°59'51"** Combination Scale Factor: **0.9999717464**

Iowa North Zone (1401) Northing: **3971276.121sft** Easting: **5312507.311sft**

IaRCS Zone 2 Northing: **9880478.545sft** Easting: **12691891.147sft**

Location: Near the NW Cor of Sec 22 T99N R10W.

Designation: WINNESHIEK COUNTY GPS CONTROL PT 2003-124

Monument Type: 5/8" dia driven aluminum rod with a 2-1/2" dia aluminum cap and permanent magnet encased in a 5" dia PVC pipe with an aluminum access cover.

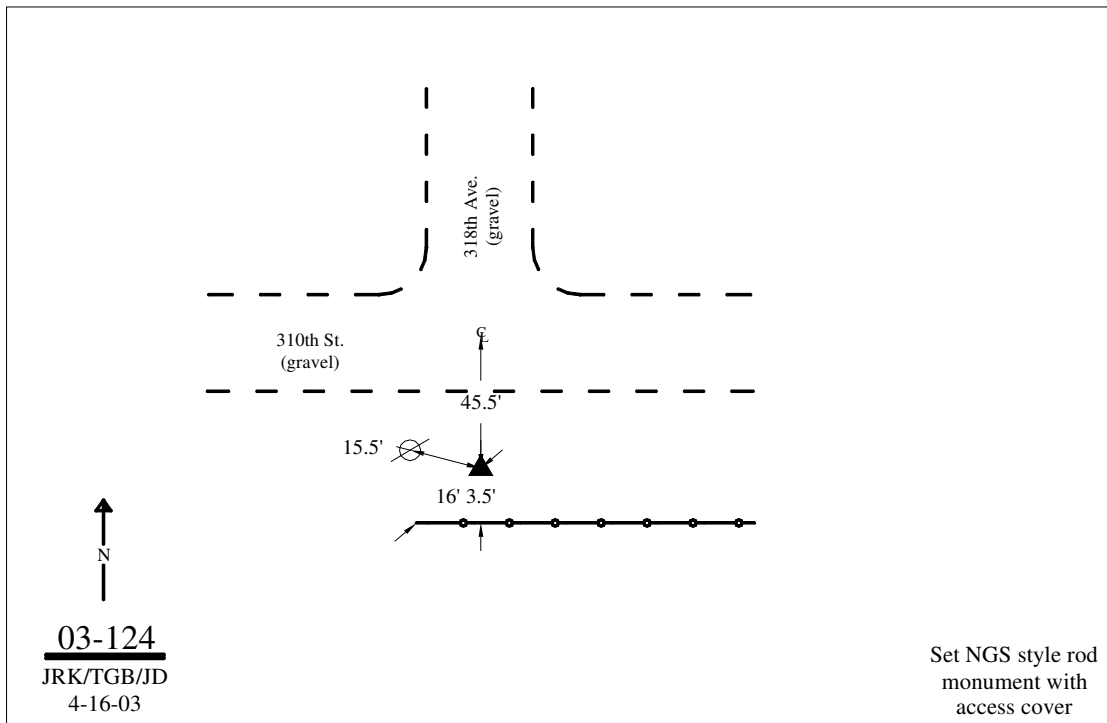

This document was prepared by DCI on February 7, 2014 for use by Winneshiek County, Iowa