

**2014 Winneshiek County, Iowa**  
Horizontal Datum: **NAD 83(2011)** - Vertical Datum: **NAVD 1988**  
Iowa North Zone (1401)  
Iowa Regional Coordinate System Zone 2 Mason City  
US Survey Feet

Point Name: **10139**

NAD 83(2011)      Latitude: **N43°17'55.92560"**      Longitude: **W92°01'19.46392"**

NAVD 88 Ortho Height: **1191.800sft**      Ellip. Ht: **1092.516sft**      **Geoid12A**

Mapping Angle: **1°00'06"**      Combination Scale Factor: **0.9999539178**

Iowa North Zone (1401)      Northing: **3939847.260sft**      Easting: **5314689.020sft**

IaRCS Zone 2      Northing: **9849030.681sft**      Easting: **12693796.548sft**

**Location:** Near the NE Cor of Sec 21 T98N R10W.

**Designation:** WINNESHIEK COUNTY GPS CONTROL PT 2003-139

**Monument Type:** 5/8" dia driven aluminum rod with a 2-1/2" dia aluminum cap and permanent magnet encased in a 5" dia PVC pipe with an aluminum access cover.

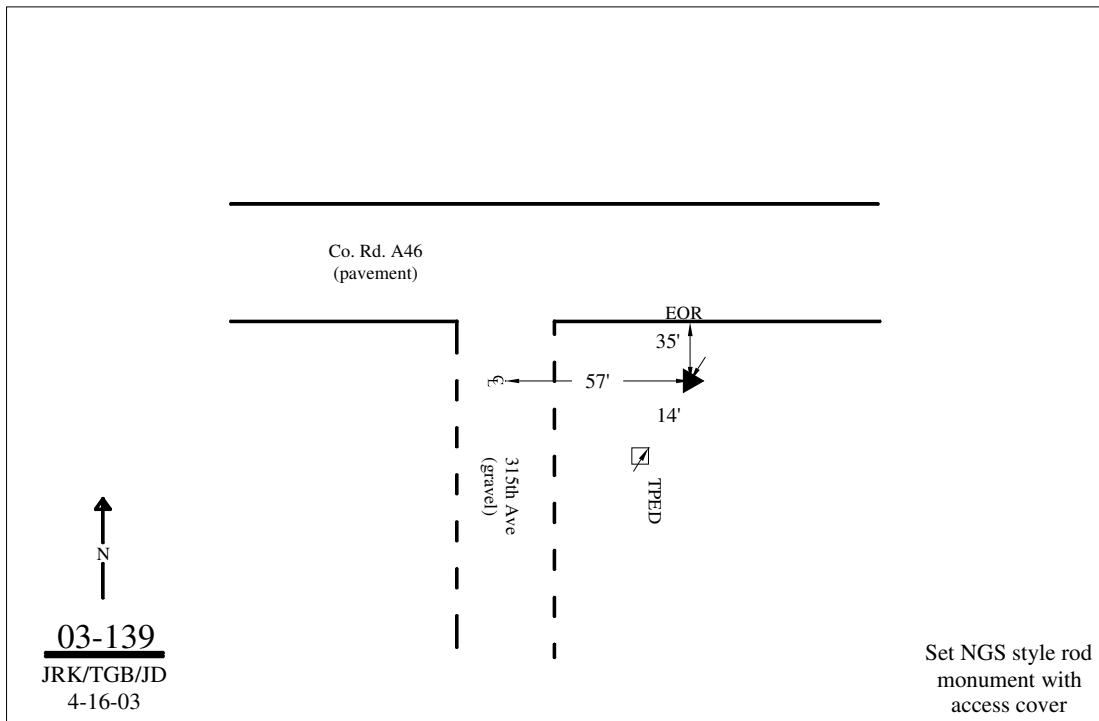

*This document was prepared by DCI on February 7, 2014 for use by Winneshiek County, Iowa*