

2014 Winneshiek County, Iowa
Horizontal Datum: **NAD 83(2011)** - Vertical Datum: **NAVD 1988**
Iowa North Zone (1401)
Iowa Regional Coordinate System Zone 2 Mason City
US Survey Feet

Point Name: **10143**

NAD 83(2011) Latitude: **N43°17'41.14955"** Longitude: **W91°46'58.47480"**

NAVD 88 Ortho Height: **946.040sft** Ellip. Ht: **847.147sft** **Geoid12A**

Mapping Angle: **1°09'49"** Combination Scale Factor: **0.9999648362**

Iowa North Zone (1401) Northing: **3939554.605sft** Easting: **5378379.038sft**

IaRCS Zone 2 Northing: **9848178.983sft** Easting: **12757484.086sft**

Location: In the NW 1/4 of Sec 22 T99N R8W.

Designation: WINNESHIEK COUNTY GPS CONTROL PT 2003-143

Monument Type: 5/8" dia driven aluminum rod with a 2-1/2" dia aluminum cap and permanent magnet encased in a 5" dia PVC pipe with an aluminum access cover.

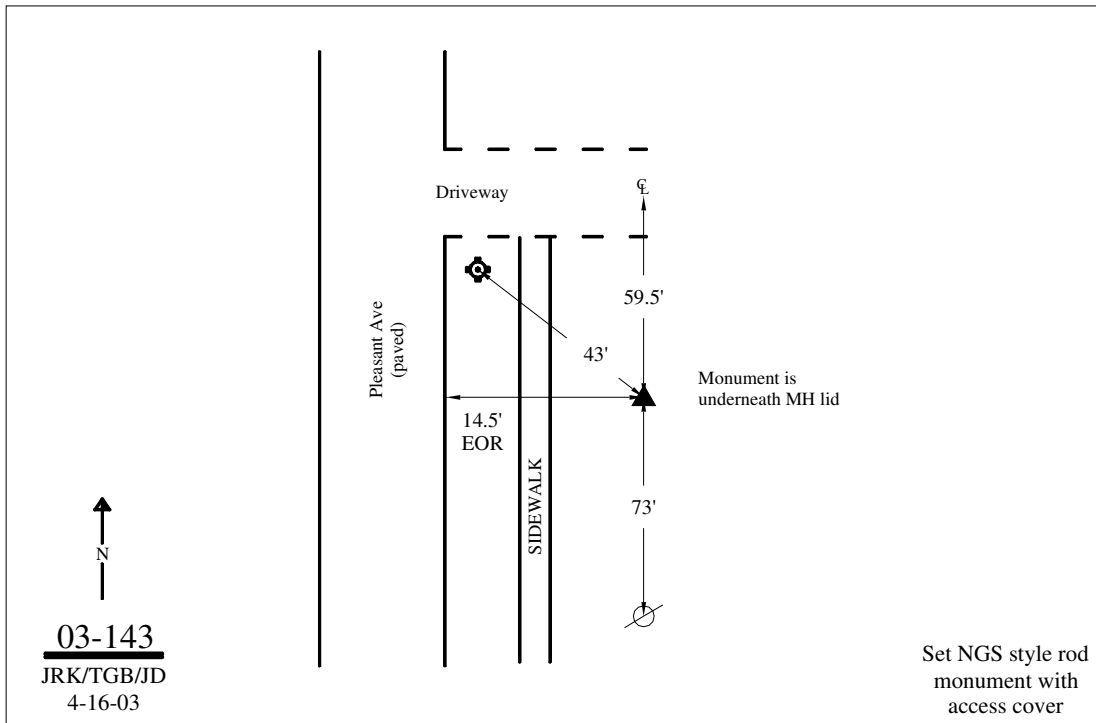

This document was prepared by DCI on February 7, 2014 for use by Winneshiek County, Iowa