

2014 Winneshiek County, Iowa
Horizontal Datum: **NAD 83(2011)** - Vertical Datum: **NAVD 1988**
Iowa North Zone (1401)
Iowa Regional Coordinate System Zone 2 Mason City
US Survey Feet

Point Name: **10150**

NAD 83(2011) Latitude: **N43°15'19.24108"** Longitude: **W91°50'36.72257"**

NAVD 88 Ortho Height: **1088.890sft** Ellip. Ht: **989.883sft** **Geoid12A**

Mapping Angle: **1°07'22"** Combination Scale Factor: **0.9999507229**

Iowa North Zone (1401) Northing: **3924867.302sft** Easting: **5362523.045sft**

IaRCS Zone 2 Northing: **9833630.629sft** Easting: **12741499.244sft**

Location: Near the SW Cor of Sec 31 T98N R8W.

Designation: WINNESHIEK COUNTY GPS CONTROL PT 2003-150

Monument Type: 5/8" dia driven aluminum rod with a 2-1/2" dia aluminum cap and permanent magnet encased in a 5" dia PVC pipe with an aluminum access cover.

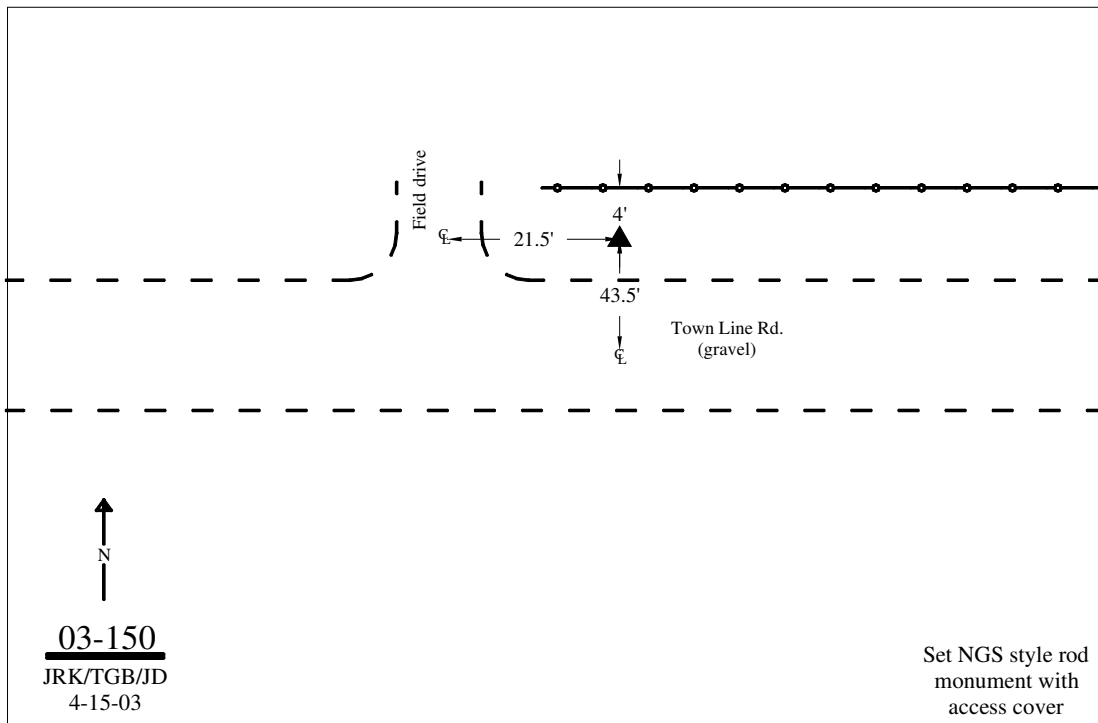

This document was prepared by DCI on February 7, 2014 for use by Winneshiek County, Iowa