

2014 Winneshiek County, Iowa
Horizontal Datum: **NAD 83(2011)** - Vertical Datum: **NAVD 1988**
Iowa North Zone (1401)
Iowa Regional Coordinate System Zone 2 Mason City
US Survey Feet

Point Name: **10152**

NAD 83(2011) Latitude: **N43°15'19.62984"** Longitude: **W91°43'25.28831"**

NAVD 88 Ortho Height: **1171.320sft** Ellip. Ht: **1072.259sft** **Geoid12A**

Mapping Angle: **1°12'14"** Combination Scale Factor: **0.9999468122**

Iowa North Zone (1401) Northing: **3925554.831sft** Easting: **5394443.127sft**

IaRCS Zone 2 Northing: **9834038.405sft** Easting: **12773425.602sft**

Location: Near the NW Cor of Sec 6 T97N R7W.

Designation: WINNESHIEK COUNTY GPS CONTROL PT 2003-152

Monument Type: 5/8" dia driven aluminum rod with a 2-1/2" dia aluminum cap and permanent magnet encased in a 5" dia PVC pipe with an aluminum access cover.

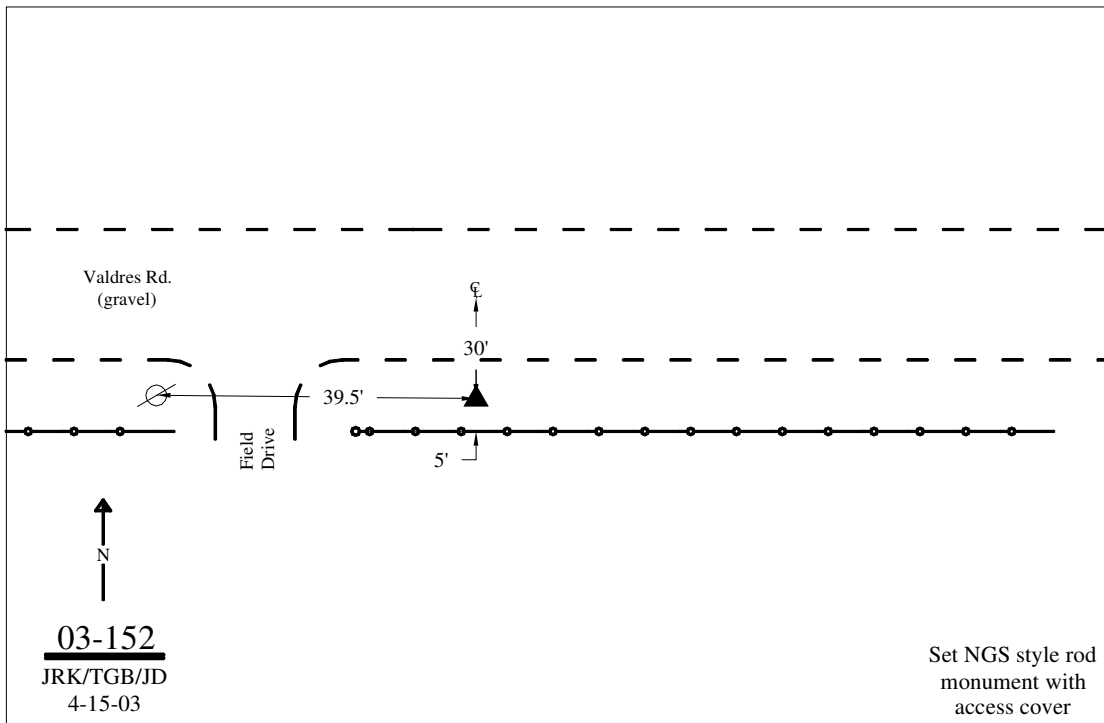

This document was prepared by DCI on February 7, 2014 for use by Winneshiek County, Iowa